

Turkey Creek Division

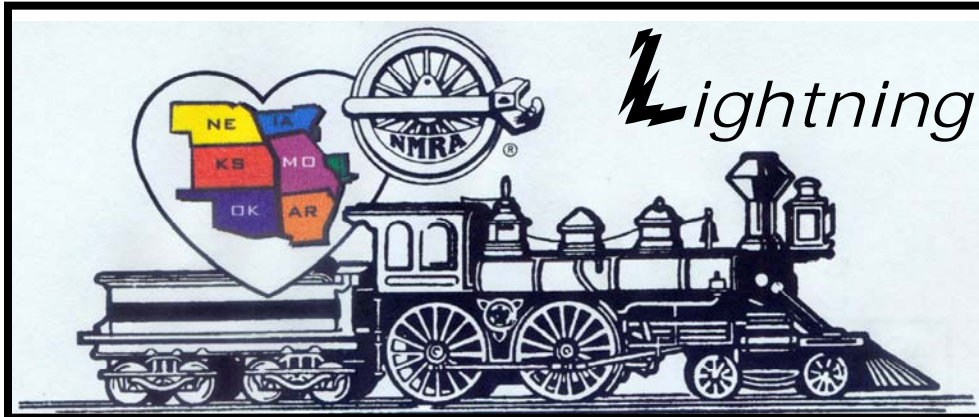

Lightning Slinger

VOL 26 NO. 1

“For all gauges and all ages”

January 2012

MONTHLY PUBLICATION OF THE TURKEY CREEK DIVISION
OF THE MID-CONTINENT REGION, NMRA

Clinic

Digital Model Railroad Photography – Updated with new material.

Clinic will show how to take magazine quality digital photos expected of natural magazines and calendars.

by Ron Morse MMR

Note NEW LOCATION *Note*

January 24th at

Antioch Branch of Johnson County Library
8700 Shawnee Mission Parkway

Shawnee Mission Parkway exit ... East to Antioch Street ... NW Corner.
Park in back on north side.



Digital Model Railroad Photography-101

By: Ron Morse, MMR

Ron has been published in national magazines and calendars over 40 times with 387 published photos to his credit. The bulk of the articles that have been published are about model railroading, ghost towns and Colorado scenery. But he has also been published in "Birds & Blooms Extra" and "Country Extra".

This clinic on Digital Model Railroad Photography has been recently updated to cover the ever changing world of digital photography.

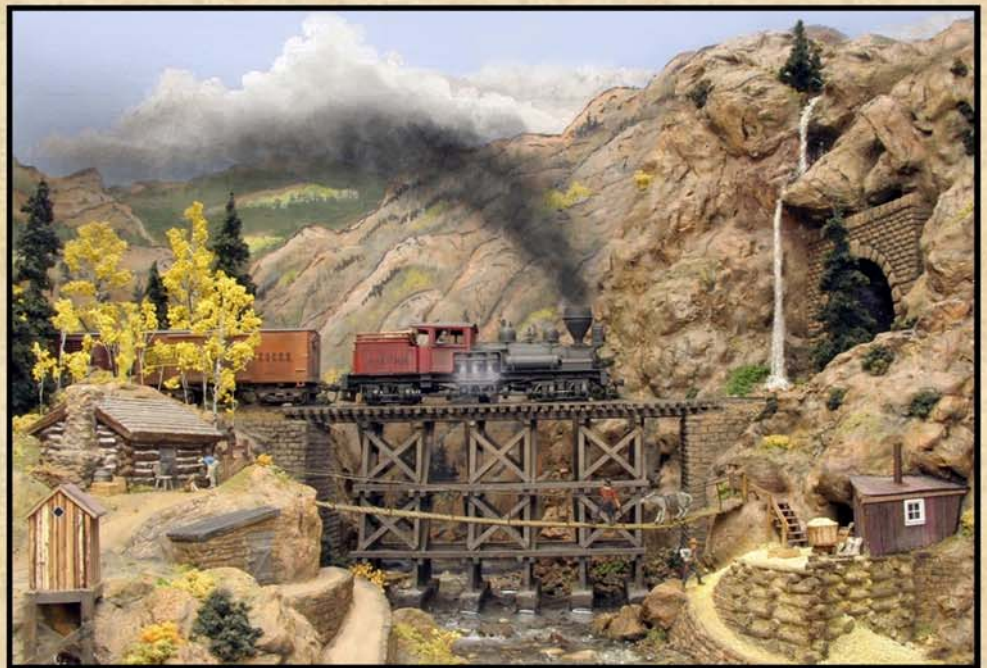
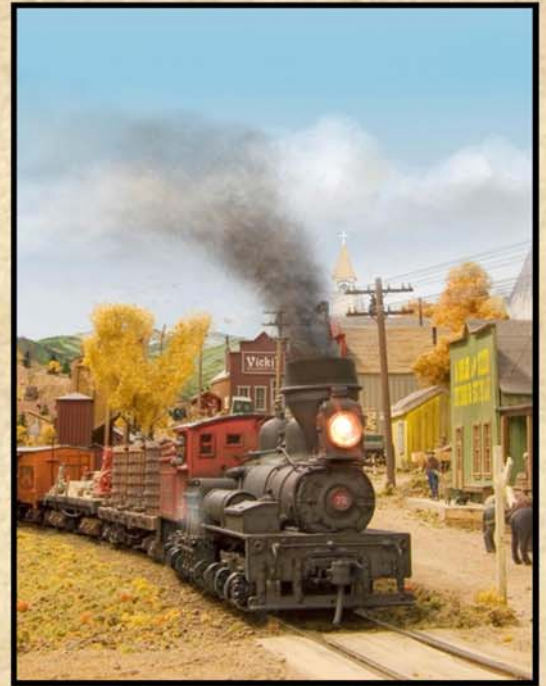

January 2012 Newsletter - Turkey Creek Division

Hello Everyone.

Starting a brand new year. Time to pull out all the stops and build yourself some new great models, get your layouts operating and have a real good time!

Our December Christmas gathering was another stellar presentation of the Colorado High Country. Great photos and good to see Ron Morse MMR out of his house. I hope all had a good evening. We had lots of wives and I hope they enjoyed the presentation. We had lots of sweets and coffee. Thank you Bob Jefferis for arranging his church's Fellowship Hall for the meeting. No Snow!!!

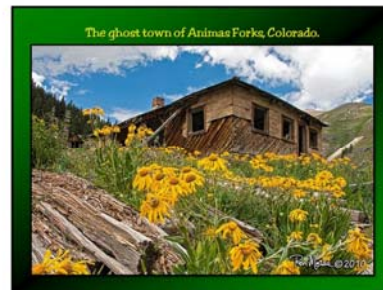
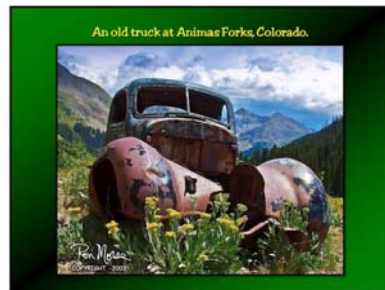

Ken Jenkins received 4 merit awards for his structures. Very Well Done Models! (sorry no photo) Ken is planning to present a clinic in February on his award winning Grain Elevators. These are all excellent structures on his Rock Island R.R. across Kansas.

Chico News Update



December 11th ... a day which pleased the Gods ... as the Gods were very kind to me when I again took Yardmaster Trainee position at Murray Yard, after I bribed proprietor Gary Hankins with a very exclusive gift! He then reconsidered to let me into his home. Paul Richardson volunteered for Murray's industries position and at my request, looked over my shoulder frequently.

But to my surprise, and all others around, I remembered how to operate the switching ladder and I arranged my receiving track car cards as soon as the trains arrived. Didn't lose a car! ... All night!

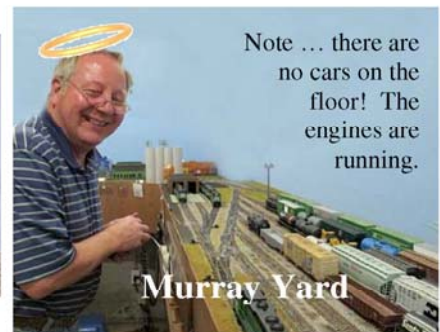

I even remembered to switch the oil industries and moved tank cars as though I knew what I was doing. Smooth! ... Smooth as silk!

No crashes! ... only a few derailments! Ran only 2 switches. I never found that set of switchers in the engine house that got slid in with the five finger hook last ops session! ... magic!

Never lost control of my locos ... I mean they never ran off into the sunset ... under their own power (of course by accident).

All evening I just felt eyes behind me! You know what I mean ...**But I had Fun!!!**



Looking forward, I don't have clinics committed for February and beyond! Need your help! If anyone has a topic they would like to present, please call me. Please take my call when I call you.

Our location for the next few meetings is going to move around. January, we will be at Johnson County Library, Antioch Branch, 8700 Shawnee Mission Parkway, which is at Shawnee Mission Parkway and Antioch. The price is right! Getting reservation is tricky! We must be first! ... Online reservation system. Requests are received starting at 12:00 midnight, 60 days prior.

2012 should be a great year. If I get half of what I want to do, I will accomplish a lot. I'm building cars and cabooses with intent of trying to get the Cars AP Certificate.

The MoKan group just finished a 24" x 120" switching layout they plan to display at the February Great American Train Show. It looks and works pretty darn well. Try your hand at switching. I'm sure you'll do better than me. The switches are all normal, so you only need single brain power. We displayed it at the Johnson County Olathe Library for developing kids' interest and had trouble keeping the adults off the controls, even our own adults!

A Look Back in History

A special tribute was made to Warren Weston MMR with pictures from April 1967 NMRA Bulletin. Warren was running for the Mid Continent Regions Secretary – Treasurer position. I believe he was successful, some 44 years ago! See attached copy.

AP Program

Brad Morneau MMR, continues to have work sessions at his house on selected Saturdays to assist persons in pursuit of their AP Certificates. It's my understanding the sessions are going very well. If you're interested, contact Brad by email: bmorneau@kc.rr.com.

Sincerely,

Larry W. Diehl
Superintendent, Turkey Creek Division

Turkey Creek Division ... NMRA (4th Tuesday each month)

January 24th
February 28th
March 27th
April 24th
May 22nd
June 26th Modeling Challenge
July 14th Division Annual Meet
August 28th
September 25th
October 23rd
November 27th
December 11th or 18th



NMRA



Bulletin

Official Publication
National Model Railroad Association

© 1967, NATIONAL MODEL RAILROAD ASSOC. INC.

32nd Year

April, 1967

No. 8

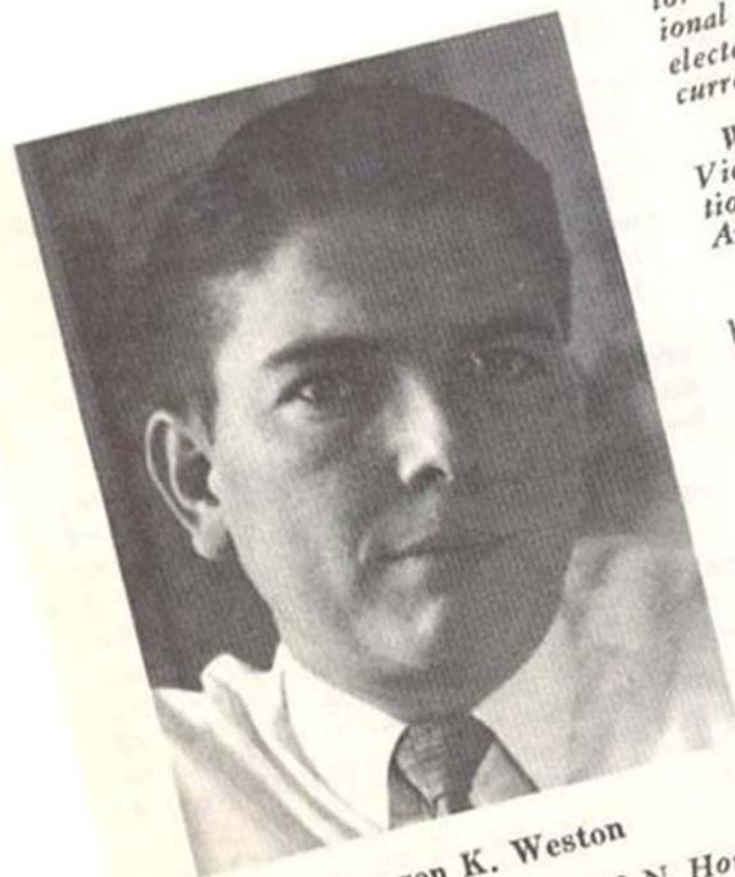

Warren K. Weston
WARREN K. WESTON, of 303 N. Howard, Lee's Summit, Mo. 64603, is 39 years of age and a member of the Mid Continent Region; a Life Member of the NMRA, and has been a modeler since 1944.
He served the Mid Continent Region as Secretary-Treasurer for two years; was Edi-

tor of MCoR Publication (1964-67), was
ional Vice President (1965-66) and
elected Region President in September, 1966,
currently serving in that capacity.

Warren's name as a candidate for Plains
Vice President has been submitted by peti-
tion in accordance with the provisions of
Article VII, Section 2 of the Constitution.

The NMRA needs to be modified
by the members insisting on a change
in emphasis to "model railroading" in
our hobby. The members must remain
the last word in the direction our hobby
must take. Progress cannot be legislated.

A Look Back in History

local dollars (where x dollars is for local
dues, y for regional dues and z for na-
tional dues). Each level would establish



THE TURKEY CREEK GOBBLER



VOLUME ELEVENTEEN AND TWO

DECEMBER 29, 1928

A RANDOMLY OCCURRING PUBLICATION

KEEPING THE BULL BUSY

Since the fire breathing bulls reeked havoc on the wood structures located at Black Rock



last year it is rumored that some are considering building brick fire houses to offer some measure of protection???



THOSE CURRENTLY SIGNED UP...

- 1.)
- 2.)
- 3.)
- 4.) **LARRY DIEHL...YES... 'HO' SCALE**
- 5.)
- 6.) **LARRY ALFRED...YES... 'O' SCALE**
- 7.) **RON MORSE, MMR...YES... 'O' SCALE**
- 8.)
- 9.)
- 10.)
- 11.)
- 12.)
- 13.)
- 14.)
- 15.)
- 16.)
- 17.)
- 18.)



*Don't get left behind...
join the fun...*

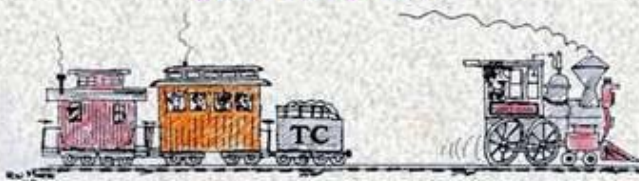

TURKEY CREEK DIVISION MODELING CHALLENGE 2012

by Rusty Rails

Here we go again! For the 9th Annual TCD Modeling Challenge, the theme returns to the very first year of the Challenge...the Square Footer is back! So, this year, you may build and enter anything, yes...that's anything...as long as it fits on a 12" x 12" (or less) base. This is the theme voted on by the members attending the modeling challenge meeting last summer.

So, what exactly does this mean for each of you? What it means is that you will not have any excuse whatsoever for not participating in the event. The playing field has been leveled, so to speak...we won't have any layout-sized dioramas (laugh). Let me emphasize here that the Modeling Challenge program was conceived to encourage everyone to participate in the enjoyment of building and displaying railroad models!! Please don't feel overwhelmed, intimidated, or that you don't have time to join in. It is hoped that by participating you will feel a sense of "inclusion", that of being "one of the group."

You may ask yourself, what sort of model could I enter? First, let me make this clarification.....entries need not be constructed especially for this event. If you have something that you built in the past, please consider entering it, as long as it satisfies the size limit. Or, if there is a new project that you have been thinking about starting, now is a good time. You could limit your entry to a single car or locomotive..... remember any scale or gauge is acceptable, from Z to whatever will fit. Alternatively, you could focus on structures and enter a single structure or a scene with several smaller buildings, perhaps with basic details or highly detailed. Whichever, this could be an opportunity to build a component of your home layout....to be incorporated into the layout at a later date. Several of the past entries have been used in this way, to a great benefit of the modeler. This is intended to be a fun filled event, with the entry possibilities only limited by your imagination, creativity, and enthusiasm to participate (and size).

The judging will be by popular vote, so crowd appeal will be important. The event will take place at our June 26th meeting, so you have more than seven months to prepare your entry. As in the past, there will be three places plus honorable mentions awarded for this challenge, plus awards for the "Most Creative" and the "Most Whimsical" entries. In addition, we will continue with an award for the "Best Animation/Sound" for those that want to make things move or make noise. But, again, I want to emphasize that the participation is the important aspect of this program. So, if you're interested in being involved, start thinking about your model entry now. There is plenty of time, but don't put it off. This will be another fun event! [more information on this in the next issue]

**TO SIGN UP-EMAIL RON AT:
ronmorsemmr@gmail.com**

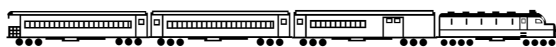

Union Pacific clarifies photo policy

<http://trn.trains.com/en/Railroad%20News/News%20Wire/2012/01/Union%20Pacific%20clarifies%20photo%20policy.aspx>

Published: January 4, 2012

Photo by Tyler Dzierzek OMAHA, Neb. Union Pacific stirred some buzz last month when it announced a new photo policy, and many railfans assumed that UP was cracking down on railfan photography. However, it turned out that UP had something else in mind.

The new photo policy sounded pretty tough on the surface, particularly a paragraph that said, "Violators are subject to a citation for trespassing on railroad property. Union Pacific will seek removal from publication any photograph or video that violates this policy." There also was a stern warning against setting up cameras between the rails for head-on run-over shots.

However, Mark Davis, a spokesman for the Union Pacific in Omaha, said those policies are not aimed at the vast majority of railfans. Less than 1 percent of railfans would deliberately do something so foolish or dangerous as digging a hole in the ballast to plant a camera, Davis acknowledged. The last time that happened, UP's safety team saw the posting of the video on YouTube and reported it to Davis. Davis pointed out that planting a camera within an active railroad track was automatically trespassing. More importantly, the big problem is imbedded in the first sentence of the policy, and was not aimed at railfans at all. It seems that a fad has begun among professional photographers to use railroad tracks as a setting for high school graduation photos. These photographers set up their tripods in the middle of mainline tracks and pose students on the tracks. In at least one case, the photographer set up inside a tunnel with the student inside, highlighted by the tunnel portal in the background.

Union Pacific police and safety teams are quite concerned about this fad, which seems to be growing rapidly. Plans are now being discussed for what to do in the upcoming graduation season. Among other things, the entire railroad police force and other UP officials may give hundreds of talks at high school convocations asking students to be careful and to report any photographer who suggests such a shot. Those photographers could get a visit from UP cops pointing out the penalties for such blatant trespassing. For railfans, the UP is not the old, hostile UP. Davis said the Union Pacific welcomes fans and welcomes the thousands of photos they take.

In fact, in the same part of the website where UP warns of dangerous trespassing, is another set of advice for railfans.

That advice, which can be found

at <http://www.uprr.com/she/policy/index.shtml>, begins, "Union Pacific Railroad has always valued the countless numbers of persons that have taken photographs of our trains and structures over the years. While we appreciate all of the photographers' efforts, we also want them to follow their passion or their profession safely."

That statement, which got little notice, explained why the new policy was articulated, including a reference to the problem with graduation photos. It even offered some advice on how not to trespass inadvertently. "While it is easy to determine rail yards and rail structures such as bridges would be off limits along the tracks, it may not be so easy to determine what is or is not railroad property," the statement said. "When in doubt, take the safe way and photograph from identifiable public property, such as the shoulder of a public road."

Davis said that even if UP police see railfans trespassing inadvertently or in some non-threatening way, they will merely point out where the property line is and guide them to public property. No one at UP is looking to harass or be unfriendly to railfans, he said.

Davis also said the UP understands that railfans can be another set of eyes for dangerous or threatening situations. Don Phillips



Da "Hammer" report..

2012 Turkey Creek Division Modeling Challenge by Rusty Rails

Here we go again! For the 9th Annual TCD Modeling Challenge, the theme returns to the very first year of the Challenge...the Square Footer is back! So, this year, you may build and enter anything, yes....that's anything...as long as it fits on a 12" x 12" (or less) base. This is the theme voted on by the members attending the modeling challenge meeting last summer.

So, what exactly does this mean for each of you? What it means is that you will not have any excuse whatsoever for not participating in the event. The playing field has been leveled, so to speak...we won't have any layout-sized dioramas (laugh). Let me emphasize here that the Modeling Challenge program was conceived to encourage everyone to participate in the enjoyment of building and displaying railroad models!! Please don't feel overwhelmed, intimidated, or that you don't have time to join in. It is hoped that by participating you will feel a sense of "inclusion", that of being "one of the group."

You may ask yourself, what sort of model could I enter? First, let me make this clarification.....entries need not be constructed especially for this event. If you have something that you built in the past, please consider entering it, as long as it satisfies the size limit. Or, if there is a new project that you have been thinking about

starting, now is a good time. You could limit your entry to a single car or locomotive..... remember any scale or gauge is acceptable, from Z to whatever will fit. Alternatively, you could focus on structures and enter a single structure or a scene with several smaller buildings, perhaps with basic details or highly detailed. Whichever, this could be an opportunity to build a component of your home layout....to be incorporated into the layout at a later date. Several of the past entries have been used in this way, to a great benefit of the modeler. This is intended to be a fun filled event, with the entry possibilities only limited by your imagination, creativity, and enthusiasm to participate (and size).

The judging will be by popular vote, so crowd appeal will be important. The event will take place at our June 26th meeting, so you have more than seven months to prepare your entry. As in the past, there will be three places plus honorable mentions awarded for this challenge, plus awards for the "Most Creative" and the "Most Whimsical" entries. In addition, we will continue with an award for the "Best Animation/Sound" for those that want to make things move or make noise. But, again, I want to emphasize that the participation is the important aspect of this program. So, if you're interested in being involved, start thinking about your model entry now. There is plenty of time, but don't put it off. This will be another fun event!

For fun, I have included below portions of the original notice of the 1st TC Modeling Challenge...also a Square Footer Challenge. Note to Superintendent Diehl – you can see that even I initially referred to this even as a "contest." However, I believe that the term "challenge" is more in keeping with the intent of encouraging participation by all members.

Diorama Contest (from 2004) By Rusty Rails

So, what can you build on a one square foot base? That's your challenge for the first annual Turkey Creek Division contest! In G scale, you could fit a RGS 50,000 gallon water tank in one square foot and not much more. In Z scale, you could probably model the Kansas City West Bot-



toms. In HO, you'll be somewhere in between.

There is no restriction on how high your scene can go, so you could model a mountain or a twelve story building. If you're into Colorado mining, you could put an ore mill on a mountain side with tracks at the bottom for cars to pick up the refined ore. If coastal railroading is your bag, then a pier scene may be for you. Another thought might be a scene with an overpass with a train on the lower and upper levels.

If you're into city scenes, you could model the backside of some trackside tenements with Mrs. McGurty waving at the engineer while she's hanging out laundry. Another scene that would be interesting would be a station with passengers waiting for a train or perhaps boarding a passenger train.

There is no restriction on the diorama except that the base cannot exceed one square foot – that's 12" by 12" maximum size. Can it be smaller? Sure. If you already have a base you want to use and it's 12" X 12" or less in size, that's fine. If you have a base that's 16" X 8", that's NOT FINE. Do you have to have a train on the diorama? Nope. It's up to you what to include.

The judging will be by popular vote, so crowd appeal will be the rule. There will be three places awarded for this contest. So, if you're entering a diorama, start thinking about your model now. There is plenty of time, but don't put it off. This will be a fun contest!

Come on guys and
gals....let's shoot for a
minimum of 25 en-
tries this year!!!!

Please join in on the fun

and

BUILD...

BUILD...

BUILD...

BUILD

BUILD

BUILD

BUILD

BUILD

Drop me an e-mail and let me know
if you will be joining the fun this
year and what scale you will be
modeling.

1.)Ron Morse, MMR...yes...'O' Scale

2.)Larry Diehl...yes...'HO' Scale

3.)LARRY ALFRED...yes...'O' Scale

4.)Steve Mckee

5.)Shelly LevY

6.)STEVE PRIEST, MMR

7.)Jim Ballinger

8.)Bob Hollowell

9.)FRAN HALE, MMR

10.)MILES HALE, MMR

11.)Steve Mckee

12.)Bob mcbean

13.)Marty Vaughn, MMR

14.)Joe Robertson, MMR

15.)PAT HARRIMAN, MMR

16.)Kent hurley



Custom H0 Scale Frisco 42' Flat Car

Sold by Texas Western Model Railroad Club • Made by Red Caboose

- **Ready to Run cars** in four numbers (includes Kadee couplers, Accurail Bettendorf trucks, IRC metal wheelsets) – **\$28.95**
- **Kits** – **\$19.95** (less t/c)
- **Wooden Decks** (laser cut/detailed) – **\$4.50**

Order online:

shop.twmrc.org/

Or call: **682-587-2092**

SHIPPING AVAILABLE

MC•VISA•Discover•American Express•PayPal•Check



Texas Western Model Railroad Club

501(c)3 Not-for-Profit Organization

6807-A Anglin Drive • Fort Worth, TX 76140 • 682-587-2092

www.twmrc.org

info@twmrc.org

TOTOTRAINS, LLC

SPECIALIZING IN EUROPEAN TRAINS
MÄRKLIN/TRIX/LGB/ROCO/FLEISCHMANN

EVERY DAY DISCOUNTS ON
WALTHERS CATALOG ITEMS: 20%-35%

HOURS: WED-SAT: 10.00AM-4.00PM

OR BY APPOINTMENT

785-766-0467

WWW.TOTOTRAINS.COM

INFO@TOTOTRAINS.COM

1031 VERMONT STREET, SUITE A
LAWRENCE, KS 66044

TRAINS & TOYS !

Mid-America Train & Toy Show
2012 SHOW DATES

March 18 ~ August 26 ~ November 25

MOVING TO

KCI EXPO CENTER

11728 NW Ambassador Drive KC, MO

I-29 exit 13

Toys, Trains, Models, RR Collectibles, Toys & More

Admission: \$5 Adults – 12/under Free w/adult

Open 9am – 2pm

7 am Early Admissions \$10.00 each

Showing Free Train Movies * Door Prizes

200 Dealer Tables * Free Parking

For more information visit:

www.MidAmericaTrainAndToyShow.com

Steve & Sherri Stich @ 913.651.5864

POB 369 Leavenworth, KS 66048

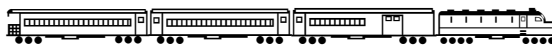

NMRA News

From NMRA InfoNet News:

In order to ensure the financial wellbeing of the NMRA into the future, there will be a dues increase on January 1, 2012 for U.S. members and overseas members served by the Chattanooga office. Regular memberships will increase by \$5 to \$44, and subscriptions to *NMRA Magazine* will increase by \$3 to \$22. Sustaining memberships (including the magazine) will increase by \$13 to \$110, and student memberships (including the magazine) will increase by \$4 to \$32. In addition, our highly successful Rail Pass trial membership program will continue at \$9.95. The current Rail-Pass conversion rate to regular memberships is around 65%. For the some reason, the story that the NMRA membership has been declining over the past few years continues to persist. IT AIN'T TRUE. NMRA membership is holding steady at around 19,500. According to the latest "Membership Thermometer" figures compiled by Marketing, Advertising and Promotions manager Tom Draper, the NMRA lost 104 members between August 2009 and August 2011, but gained 91 members between August 2006 and August 2011. Please help us set the record straight by mentioning this to your membership!

Convention news: Even though Grand Rails 2012 will have dozens of top notch model railroads open for self-guided tours, the convention committee wanted to make sure everyone has a chance to see some of their great layouts. So there will also be several bus tours to some of the area's best layouts. Layouts include every scale from Z to G, and every level of completion. They're also offering a very special, exclusive seven-hour limo layout tour for groups of 6 to any of the six layouts on the self-guided list. The price for the limo is only \$120 per person. Get all the details and registration info at www.gr2012.org.

[Check out Grand Rails 2012 National Convention's web site! Grand Rapids, MI has a great convention planned! AM

OFFICERS

Superintendent

Larry W Diehl
913-338-2300
ldiehl@aci-boland.com

Paymaster

Robert M Spurgat
spurgat@ponyexpress.net
(816) 233-0046

Clerk

Robert Jefferis
Jeffbobj@everestkc.net
(913) 631-4441

Division Director

Louis O Seibel
HP: 913-393-3495
C: 913-927-6850
L-seibel@comcast.net

Train Show Chairman 2011

Louis O Seibel
HP: 913-393-3495
C: 913-927-6850
L-seibel@comcast.net

Membership Chair

Jack Rosenfield
913-451-2177
rosenfieldjack@gmail.com

L S Editor

Ted Tschirhart
HP: 816-861-3449
tedtschi@kc.rr.com

Lightning Slinger
lightnings@kc.rr.com
Nov Deadline
Oct 28 2011

AP Merit Awards & Achievement

Joe B. Robertson, MMR
HP: 816-331-2773
piperva@aol.com

Past Superintendent

Shelly Levey
913-438-7065
shellylevy@everestkc.net

Web Master

Paul Myers, MMR
HP: 816-734-3719
paulwmyers@kc.rr.com

Web

<http://www.tc-nmra.org>
Turkey Creek Division
IS A 501(C) (3)
ORGANIZATION



- 17.)Ken Jenkins
- 18.)LARRY PATCH
- 19.)Floyd Brittan
- 20.)SHELLY LEVY
- 21.)Bob Jefferis...
- 22.)CHARLES STAPLETON, MMR
- 23.)Dave Jacobs
- 24.)Fred HuleN
- 25.)CHUCK HEYING, MMR
- 26.)John Breau
- 27.)Kerry lindenbaum
- 28.)Gary Davidson
- 29.)Gary Hankins
- 30.)Roger Quinlan
- 31.)Bob Bayley
- 32.)Paul Richardson, MMR
- 33.)Bob Miller, MMR
- 34.)David E. Lindquist
- 35.)Keith Jordan
- 36.)Mike Fyten..
- 37.)Warren Weston, MMR
- 38.)Bill Craig
- 39.)Mike Porter
- 40.)Paul Myers
- 41.)Jack Boren
- 42.)Lon Johnson
- 43.)RICK MCCLELLAN, MMR
- 44.)Bill Humenczuk
- 45.)Bill Hirt
- 46.)Wm. B. Alpert
- 47.)Dr. James Budde
- 48.)Charles R. Hitchcock, MMR
- 49.)

Ron Morse, MMR

Morse Productions

ronmorsemmr@gmail.com

or visit my BLOG site at

<http://morseproductions.blogspot.com/>

Lawrence Model Railroad Club

Attention all train enthusiasts! Can you hear the train blowing its horn in the Distance? Of course, that means the 11th annual Lawrence Train show is just around the bend and nearing the station! Are you excited yet? I know I am!

With just less than a month away our vendor tables are nearly gone, our door prizes are steadily coming in, and our layouts are getting the finishing touches for the show. Rolling Stock is getting weighed, engines lubed, decoders are being programmed for running at the show, are you getting ready too? We also have a model contest, interactive switching layout, and a Geo tracks for our youngest engineers.

If you have not had an opportunity to contribute to our show supporting the needs of the Lawrence Interdenominational Nutrition Kitchen (L.I.N.K) please send your donation soon as the station is getting closer everyday! We have already received sponsorship from our valued supporting partners, BPL Brassworks, Blair Line Models, Ron's Books, Xuron corp., Micro Engineering, Inter Mountain Railway, Micro Scale, Micro-Trains, Tomar, White River Productions, Woodland Scenics, N Scale Architect, Rix Products, Radio Controlled Products, and Pricom Design .

We need valued partners to make our show a success and continue to support the L.I.N.K. with a portion of our proceeds. I found a link to a youtube one of our unknown visitors shot and posted, check it out!

<http://www.youtube.com/watch?v=Eq-GCQUoLHE> We also have our club web site:

<http://lawrencemodelrailroadclub.org> and we have a facebook page also!

You can access forms on our club web site, or you may send your donations to:

Jim Taylor

LMRC Show Coordinator

1805 Delaware St.

Lawrence, KS. 66044

Hope you join us February 18th 9:00 to 5:00 PM at the Douglas County Fairgrounds for the 11th annual Train Show and Swap Meet!



Turkey Creek Division in 2011

The following persons in the Division were published in the year 2011:

Paul Richardson MMR in the HOn3 2010 Annual for his "Vista Verte" special DRWG observation.

Ron Morse MMR in December 2010 for his Cover Photo and article "Snow Trains to Silver Plume"

Pat Harriman MMR in the On30 2011 Annual for his article on scratch building cars for the Oregon Coast Mining Co. RR (2 pages)

Pat Harriman MMR in the June NMRA magazine for his Cover Photo and article "Last Run of the Shelter Bay Railway Company" (14 pages)

Joel Priest in the June NMRA magazine for his article "A New V&O generation" (4 pages)

Dr. Vance Reed in the May/June N-Scale magazine for his Cover Photo and article "Borders 1936 Butter Dish Milk Cars" (11 pages)

Joe Priest in the July NMRA magazine for his article "A New V&O Generation – Part II" (7 pages)

Joel Priest in the August NMRA magazine for his article "A New V&O Generation – Part III" (4 pages)

Louis Seibel 2nd Quarter Caboose Kibitzer for his cover on The UP 844 The Little Rock Express and (page17)

Larry Diehl and Marty Vaughn MMR for their Contest Winner Photos in September NMRA magazine

Joel Priest in the September NMRA magazine for his article "A New V&O Generation – Part IV" (5 pages)

Joe Robertson MMR in the October NMRA magazine for his Cover Photo and article on his Piper Valley RR
Larry Diehl got model contest photo show cased on the 2011 NMRA calendar "June" month

Pat Harriman MMR almost every month NMRA magazine for his structure drawings

Ron Morris MMR Vicki Jo Mine article in the Narrow Gazette

Larry Diehl 3rd Quarter Caboose Kibitzer for his Cover Photo of "Best of Show" model at Norfolk, NE

The following awards and certificates were presented to Members of the Division in 2011:

February:

Robert Spurgat, 19 merit awards

Bill Scheerer, several merit awards

Bill Scheerer, Gold Spike and Electrical AP Certificate

March: Robby Spencer, 2 merit for cars

Larry Diehl, 9 merit awards structures

Larry Diehl, Structures AP Certificate

April:

Brad Moreau, Association Official AP Certificate

Shelly Levy, Association Volunteer AP Certificate

Ken Jenkins, Master Builder Scenery AP Certificate

Gary Davidson, Chief Dispatcher AP Certificate

May: Bill Scheerer, Association Volunteer AP Certificate

Ted Tschirhart Association Volunteer AP Certificate

June: Brad Morneau Kenny Cline Award

July: No meeting.

August:

Bob McBean, 3 merit awards for Structures

Don Bronec, 2 merit awards for Structures

Dr. Vance Reed, 1 merit award for Structures

Joel Priest, 4 merit awards, 1 for Cars, 3 for Structures

September: None

October: None

November:

Dr. Vance Reed, Structures AP Certificate

December:

Ken Jenkins 4 merit awards for Structures



EAST SIDE

↑ SOUTH SIDE

WESTSIDE

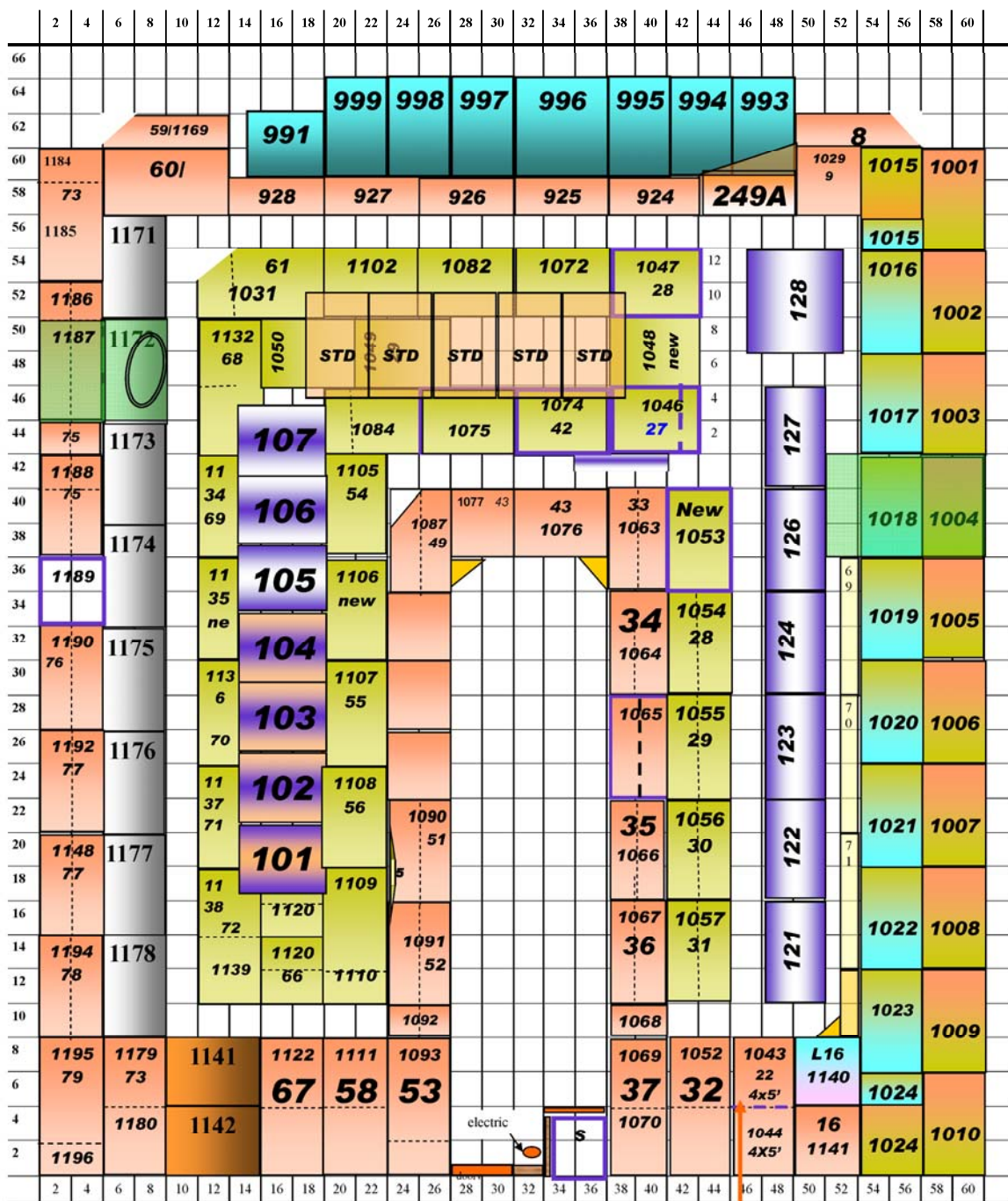

Doorway was 9'7"
Now 10'

This is the plans for the Union Station Kansas city, 2009 Christmas display in the grand Hall.

Start setup first Saturday of September taken down first week end January.

Over 100 tables to make the over size of 64' 60'. Could run 54 trains, street cars, Rdc and Doodlebug,

Trains ran 7 days a week, closed Christmas day only,

It was view by est. 112,000 people.

It was built and run by Union Station Volunteers.

On the next page is the drawing for the bench work by Ted Tschirhart .

Tables where built over 3 year time span.

By Ted Tschirhart

STD-G-O-S-HO-N-Marklin
UNION STATION 2009 TED 816-861-3449

1 1/12/2012

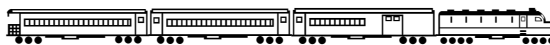

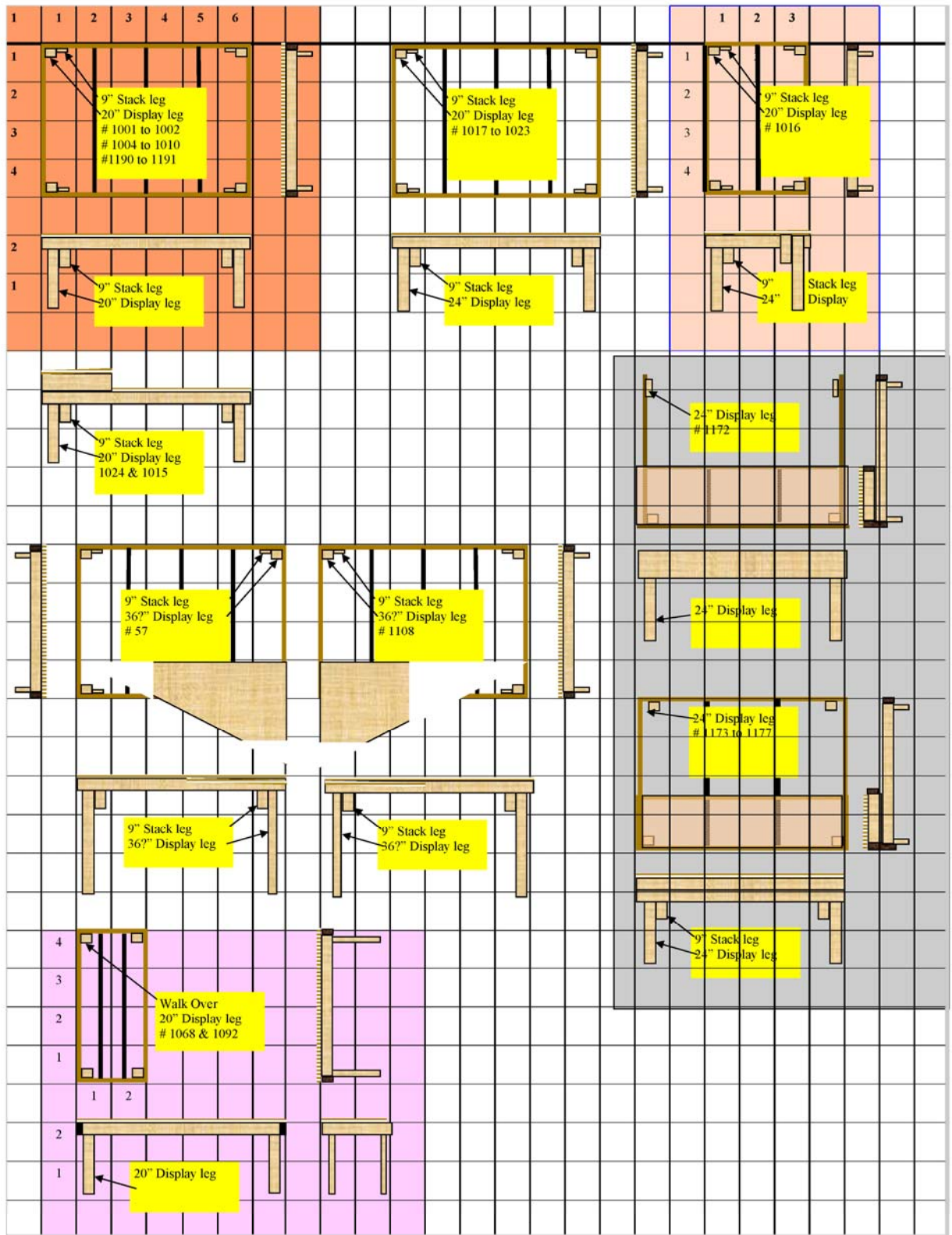

70	1"x4"x12"
35	2"x4"x12"
4	1"x10"x12"
2	2"x8"x12"
12	4'x8' 5 ply wood 1x2"

STD-G-O-S-HO-N-Marklin UNION STATION 2009 TED 816-861-3449



THE SWITCHING LIST

*=new since last issue

The Switching List contains all known Mid-Continent Region, NMRA, train shows and Division meetings. It also lists all known club shows and swap meets in the Mid-Continent Region (IA, IL, MO, AR, NE, KS, and OK). To list your event, send it to: glhemmingway@cox.net, or Gary Hemmingway, 3201 SW Stone Ave., Topeka, KS 66614. To subscribe, or unsubscribe, to The Switching List send an email to the above link. Look for us on the MCoR web site: www.mcor-nmra.org. Put me on your newsletter list. NOTE NEW E-MAIL ADDRESS

DIVISION MEETINGS

KANSAS CENTRAL DIVISION Meetings are at 1:00 pm. For the full schedule check the MCoR website or email: garyonho@cox.net. The next meeting **February 4, 2012 Tom Katafiasz**: 2105 Northwood Ln, Salina, KS: Turn off Interstate 70 south on Ohio Street, Turn Left (East) on Iron Street and go to top of hill, turn Right (South) on Marymount Road go past the stop light, turn left (East) on Northwood (first street past stop light) Tom's house is on the corner (first one on your left (north)) once you turn onto Northwood. anniversary convention.

GATEWAY DIV. (ST. LOUIS, MO) meets 3rd Monday each month, 7:00 P.M. Odd numbered months: Trinity Lutheran Church, 14088 Clayton Road at Woods Mill Rd (Hwy 141), Ballwin, MO; Even numbered months: VFW Hall, O'Fallon, IL <http://www.gatewaynmra.org/division.htm>

TURKEY CREEK DIV. (KANSAS CITY, MO & KS) monthly meetings 4th Tuesday, 7:00 P.M, Antioch Branch of Johnson County Library, 8700 Shawnee Mission Parkway, Overland Park, KS.

WESTERN HERITAGE DIVISION (OMAHA, NE / COUNCIL BLUFFS, IA) meets second Saturday (except June and December) at noon in the Sump Library at 2nd & Washington Streets in Papillion (across from Runza). Visit whdnmra.info for more info and a map.

EASTERN IOWA DIVISION
The Eastern Iowa Division will hold its Winter/Annual Meeting February 4, 2012 at the First Christian Church, 510 East 15th Street in Davenport, IA. We will keep the annual meeting short so that we can hand out AP awards and conduct the silent auction and Bring & Brag/Show & Tell. While the agenda is still being firmed up, hopefully we will have some layout tours and possibly an operating session.

KATE SHELLEY DIVISION meets on the 4th Thursday of each month at the Ames Public Library, Ames, IA, from 7 to 8:45 pm. In November we meet on the 3rd Thursday. Call Superintendent from NMRA web site for latest information. All are welcome to attend the meetings. The library is located at 515 Douglas Ave. We meet in the upstairs meeting rooms. December we have NO meetings due to the holidays.

PLATTE VALLEY DIV. (HASTINGS, GRAND ISLAND, KEARNEY, NE) meets 2nd Tuesday of each month at 7:00 p.m. in members homes on a rotating basis. Info: John O'Neill, MMR, Div. Dir., 308-384-5011 or jponeill@computer-concepts.com.

WESTERN KANSAS DIVISION (GARDEN CITY, KS) Meets every Tuesday evening from 6:30 P.M. to 9:00 P.M. at 4091/2 N. Main St. (second floor above "Stage" department store) 7 layouts on display (2-HO, 5-N) Operating sessions available Info: Robert Simmons, Division Director (620) 521-3591 or ras@odsgc.net

INDIAN NATIONS DIVISION Unless otherwise specified, all Indian Nations NMRA meets are held at the new Hardesty Library, 8316 E. 93rd. St., just east of Memorial Rd. in Tulsa, OK. The library opens at 9:00 am and the meetings start at 9:30 am. Web page: www.tulsanmra.org Superintendent - Dave Salamon (918)272-5512 or drs_rr@yahoo.com

OK Heartland Division of the NMRA meets in the even months in the Oklahoma City area. All who are interested in Model railroading are welcome. Info: www.okcnmra.org

Cowboy Line Division (Norfolk, NE) meets 3rd Thursday each month, 7:00 P.M. at HyVee East upstairs meeting room. Corner of 1st Street and Norfolk, Ave. Info: Dennis Brandt, Div. Dir: 402-9925-2415 or email dennisbrandt44@gmail.com for more information.

Division Directors, Train Show Chairs, or Club Show Chairs: Let's get the word out about your 2012 event! Get your information to Gary at any of the above addresses. **The Switching List is a service of Mid-Continent Region, NMRA.**

TRAIN SHOWS & MEETS

***JAN 28, 2012—THE GREAT TRI-STATE RAIL SALE.,** The La Crosse Center, 2nd & Pearl Streets, La Crosse, WI, 10 am – 5 pm, Railroad Show, Flea Market, Swap Meet, guided tours of steam locomotive, caboose and Grand Crossing tower, Adm: \$5.00 children under 12 free w/pd adult, BNSF Railway locomotive display at North La Crosse Yard, Canadian Pacific Railway exhibits and displays, proceeds go to maintain and restore the La Crosse Short Line Railroad Museum, Info: The 4000 Foundation Limited, P. O. Box 3411, La Crosse, WI 54602-3411, 608-781-9383, www.4000foundation.com

JAN 28-29, 2012—GREAT TRAIN EXPO, Mid America Center, Council Bluffs, IA.

FEB 4-5, 2012—GREAT TRAIN EXPO, St. Charles Convention Center, St. Charles, MO.

FEB 11-12, 2012—WICHITA TRAIN SHOW & SWAP MEET, CHISHOLM TRAIL DIV., NMRA, Cessna Activity Center, 2744 George Washington Blvd., Wichita, KS, Sat: 9-6, Sun: 11-4, Swap tables, Modular Layouts, Switching Contest, Model Contest, Photo Contest, Live Clinics & much more;



Adm: \$6.00 for both days, Advance Table Registration includes 2 admission tickets, Before 12/31/2011 take off 10%, 8 foot tables are \$25 each, Info: mail registration to Phil Aylward, 603 Chestnut, Halstead, KS 67056-2302 or aylward1@cox.net

FEB 18-19, 2012—GREAT TRAIN EXPO, American Royal Complex, Kansas City, MO.

FEB 25, 2012--SUGAR CREEK MODEL RAILROAD AND HISTORICAL SOCIETY NINTH ANNUAL GREAT NWA MODEL TRAIN & HISTORICAL MEMORABILIA SHOW, Holiday Inn & NWA Convention Center 1500 S 48th Street, Springdale, AR 72762 (Interstate 540 exit 72 onto HWY 412 on East side of Interstate 540), 9:00 AM - 4:00 PM, Admission: Adults \$6.00 and Children 12 and under FREE (\$1.00 off w/nonperishable food item Contact Information: Keith Johnson 479-871-2802 email train072@cox.net or sloojb@cox.net NWA Train Show P O Box 1283 Farmington, AR 72730 Club Website: www.railroadclubsugarcreek.org

MAR 17-18, 2012—CISCO JUNCTION MODEL RAILROAD GROUP TRAIN SHOW, The Cisco Center, North Eldon St., Cisco, IL, (exit 156 between Champaign and Decatur), Sat: 9 am- 4 pm, Sun: 9 am – 3 pm; Admission \$3.00 adults, Children 12 and under free w/pd adult, 5 operating layouts, Goodchild Brothers Circus layout, Children's Door Prizes, Breakfast and Lunch available, vendor and swap tables, Silent Auction, Info: Don Ploch, 10408 E. Washington St. Rd., Argenta, IL 62501, 217-669-2261 don@ciscojunction.com, or Randy Bennett 309-369-9600.

MAR 23-25, 2012--3RD ANNUAL TULSA AREA LAYOUT DESIGN AND OPERATIONS WEEKEND, INDIAN NATIONS DIVISION OF THE NMRA, HOSTS: We have a great weekend of operations lined up and a full day of presentations on Saturday: **Lance Mindheim** – *Planning and Designing a Switching Layout*; **Lance Mindheim** – *Modeling Prototype Switching Operations*

Steve Davis – *Computer Switchlists for Model Railroads: Why? And HOW to do it for FREE!*

John McBee with Dick Hovey - *What Time Has Taught Me About My HO Scale Pueblo Division*

Jim Senese/Tom Fausser/Dave Salamon – *How we operate our model railroads: variations in car forwarding systems.*

Additional Activities include:

32 Square Foot Layout Design Challenge – Open to everyone! Bring your track plans, photos, display boards and mockups to share with everyone, great place to solicit feedback on your layout! Panel question and answer discussion 3 Operating sessions with several layouts available for each session. The cost is \$35.00 to get in and that includes an self serve sandwich bar which includes sides and a drink. There are shirts available also for those who are interested. Operation sign ups are by first come first serve. Here is the web page address, it will be updated over the next several days with a PDF copy of the registration, Hotel information and also the Layout Design Challenge PDF is going to be posted for those that are interested in participating in that event. The Pay Pal portion is live and can be used

today to register. <http://ldopsigmeet.tulsanmra.org/>

If you have any questions please don't hesitate in getting in touch with me. Dave Salamon

Indian Nations Division Superintendent and Tulsa Area LD/OP weekend Chairman Deep River Southern - N Scale
www.picturetrail.com/salamon

***MAR 31, 2012—JOPLIN MUSEUM COMPLEX TRAIN SHOW AND SWAP MEET**, Schifferdecker Park, 7th and Schifferdecker Streets, Joplin, MO; 9am to 3pm, Included will be several operating model railroad layouts along with over 65 tables of items for sale or trade. Admission is \$3 adult, children 12 and under admitted free w/pd adult. All proceeds at the door go to benefit the Joplin Museum Complex. For further information or table rental call Rick Gardner at 417-673-4888 or email rickgardner@sofnet.com. Tables rent for \$15 each. On the web at www.tristatemodelrailroaders.com

APR 14-15, 2012--18TH ANNUAL TRAIN SHOW, D&N EVENT CENTER, 501 East Walker Road, North Platte, NE, April 14th and 15th, 2012. Sponsored by the Nebraska West Central Division, Hours 9 to 5 Saturday the 14th, 10-4 Sunday the 15th, Admission: \$3.00 children under 12 \$1.00, Under 5 free with paid adult, Tables \$10 till April 1st then they will be \$15. Union Pacific tours on Saturday only are an extra fare item. For information contact: Gene R. Tacey, P.O. Box 485, Sutherland, NE 69165, 308-386-2489, taceys@gpcom.net

***APR 21, 2012-- 35TH ANNUAL OZARKS MODEL RAILROAD SHOW AND SWAP MEET**, at the fieldhouse at Central Bible College, Grant Avenue and Norton Road in Springfield, MO, 9am to 3 pm.. This is a new location for us. For now information is available from Ron Williams, MMR, at 417-883-5350 or rjwilliams1@mchsi.com.

***MAY 30-JUN 3, 2012—MID-CONTINENT REGION CONVENTION**, Holiday Inn, Southwest Convention Center at Watson Rd and Lindberg Blvd. in Sunset Hills, MO; special room rate of \$89.00 per night. 44 Clinics given by noted model railroaders, including Tony Koester, Bill Darnaby and Mont Switzer. Layout prototypical operating sessions on three nights, More than 40 quality layouts open for your inspection, self-guided tours so you can visit on your own schedule and stay as long as you wish, Visit the Union Pacific Car Shop in Desoto, Mo and Gateway Rail Services in Madison, IL, plus an interesting industry tour. Enjoy some of the local activities that St. Louis has to offer: the Museum of Transportation, the Gateway Arch, St. Louis World famous Zoo and many more for your enjoyment. NMRA Model Contest including Judged, People's Choice and Display. Awards Banquet on Saturday evening with Mississippi River Jazz to entertain you. *Registration options include conventional mail-in and on-line with payment by check or PayPal.*

Go to the Gateway website <http://gatewaynmra.org/2012> for full details and options.

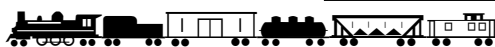

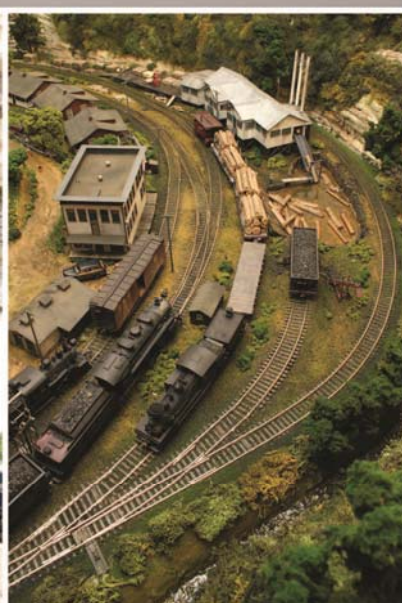

St. Louis: Your Gateway to Model Railroading Fun

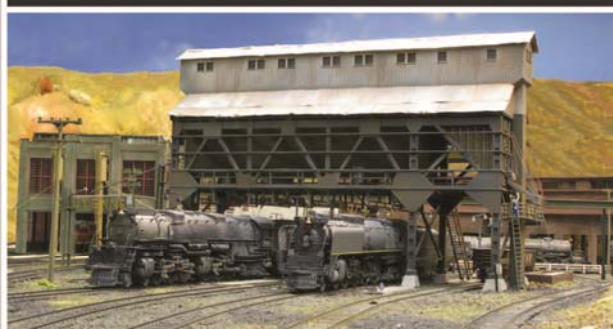

2012 MCoR Convention: May 30 through June 3, 2012



- Attend clinics by noted model railroaders, including Tony Koester, Bill Darnaby and Mont Switzer.
- Visit more than forty model railroad layouts.
- Experience guided tours of the Union Pacific Car Shop, Gateway Rail Services and American Model Builders.
- Operate on great local model railroads.
- Enter the model and photo contests, enjoy St. Louis activities, and dine at the Awards Banquet at the Transport Museum.



For more info or to register online: www.gatewaynmra.org/2012

The 2012 Mid-Continent Regional Convention is hosted by the Gateway Division NMRA, May 30 through June 3, 2012, in St. Louis, Missouri. We've added an extra day this year for more activities, more clinics, more layouts, and more value for you. The convention, train show, and hotel are all under one roof at the Holiday Inn Southwest Convention Center at Watson Rd. and Lindbergh Blvd. in Sunset Hills, Missouri, with a special room rate of \$89 per night.



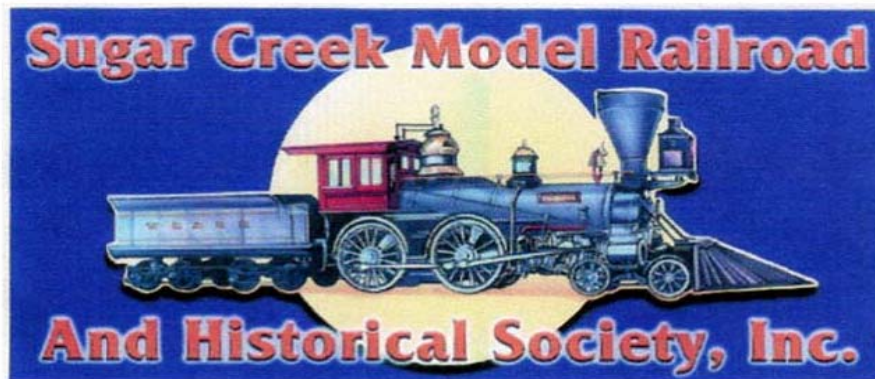

The NINTH Annual

GREAT NWA MODEL TRAIN SHOW

**HOLIDAY INN NWA CONVENTION CENTER
SPRINGDALE, ARKANSAS**

**SATURDAY
February 25, 2012**

From 9:00am to 4:00 pm

Admission \$6.00

**\$1.00 off with non-perishable food item
or this add**

Children 12 and under FREE

**GRAND PRIZE DRAWING
AMTRAK "Texas Eagle"
2 free round trip tickets**

**There will be door prizes, clinics,
model contests & much more**

**For information about the show , please
Contact: Keith Johnson @ 479-871-2802
e-mail: train072@cox.net
www.railroadclubssugarcreek.org**



TURKEY CREEK DIVISION
4954 Marsh Avenue
Kansas City, MO 64129-2111



FIRST CLASS MAIL
ADDRESS SERVICE REQUESTED 4955

mcor-nmra.org/divisions/turkeycreek/

Your NMRA membership entitles you to these benefits:

Kalmbach Memorial Library

One of the world's largest "railroads-only" libraries. Contains prototype and modeling books and magazines, out-of-production kit instructions, and more.

- www.nmra.org/library
- Call: 423-892-2846
- Fax: 423-899-4869

Email Brent Lambert: lib@hq.nmra.org

NMRA Online Archives

Over 10,000 photographs, slides, plans, drawings, erection elevations, paint schemes, and more, with additional scans being added all the time. High resolution files are available for download at a discount to members.

www.nmra.org, click "Online Archives" button

"Members-Only" website

This portion of www.nmra.org contains content exclusively for NMRA members, including reprints of Region and Division newsletter articles, newly updated Data Sheets, reprints of articles from classic NMRA magazines, downloadable calendar photographs and screensavers, and much more. This area is constantly being updated so check back often! www.nmra.org, click on "Members Only"

NMRA Company Store

The NMRA's Company Store offers many items, from apparel to mugs to gauges, available only to NMRA members. www.nmra.org, choose "online store", then "Members-Only Company Store"

Turkey Creek Division of the NMRA Meetings and Events for 2012

Meetings are on the 4th Tuesday each month

- January 24th February 18th and 19th the Great Train Expo, American Royal Building, Kansas City, MO February 18th Lawrence Model RR Club Show
- February 28th ● March 27th ● April 24th
- May 18th to 20th Thousand Lakes Region Meet ... Sioux Falls, South Dakota May 22nd May 30th to June 3rd Mid-Continent Regional Meet St. Louis, MO
- June 26th Modeling Challenge June ? Kansas City Narrow Gauge Meet
- July 14th Division Annual Meet July 29th to August 4th NMRA National Convention ... Grand Rapids, Michigan
- August 28th ● September 25th

