

# Lightning Slinger

## Turkey Creek Division

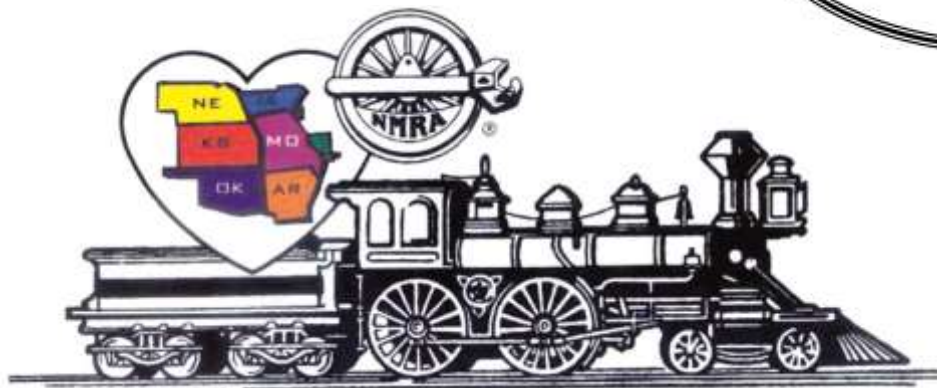

VOL 35 June 2020

MONTHLY PUBLICATION OF THE TURKEY CREEK DIVISION  
OF THE MID-CONTINENT REGION, NMRA

**"For all gauges and all ages"**

June 23, 2020

7:00 pm

### **NEW LOCATION**

First Baptist Church of Kansas City, Missouri  
100 W Red Bridge Rd. KCMO

Make & Take Clinic  
by  
Larry Long

### **Facemasks Required**

Fellow Model Railroaders. I have decided to go ahead and have an in person Turkey Creek Division meeting for June. It will be our annual Make and Take clinic. I would like to thank Bill Humenczuk for finding a place to hold this meeting and making the necessary arrangements. I am going to require masks and for them to be properly worn while in the building. I tired of seeing pictures of masks protecting chins. Everyone attending the meeting will be asked to sign in and leave contact information. Larry Diehl will be doing a presentation for the clinic. If you decide to attend, you have several options:

- Attend the presentation and stay and work on your kit;
- Attend the presentation, pick up your kit, and leave; or
- Just pick up your kit and leave. If you wish to pick up you kit with minimal contact, you can call my cell number 785-760-5040 from the parking lot, and I will ask someone to bring your kit to your car.

I would like to have a rough feeling for who is going to attend and what attendees are planning to do. For example, if no one is planning to stay and build the kit, then no reason exists for Larry to bring the necessary materials and set up. Please let me know by Tuesday morning if you are planning to attend and which of the above options you are considering: [gcohlmac@sunflower.com](mailto:gcohlmac@sunflower.com).

For those of you who have purchased a kit and are not attending the meeting, I will hang onto your kit. I will bring them to future meetings or we can arrange a minimal contact rendezvous to allow you to get your kit. Keep in mind that I live in Lawrence and may not want to drive to your house.

I thought the virtual meeting last month went well. I apologize for losing the PowerPoint feed during the presentation, but we did get it back. One item that came up was the difference between the model challenge and the model contest. I will attempt to clarify:

- Model challenge: This is the division yearly meeting where only members bring in models, are asked to talk briefly about the model, and there is a popular vote. This meeting lacks NMRA Achievement Program judging. It occurs at a regular scheduled Tuesday meeting.
- Model contest: This normally occurs at our annual Turkey Creek Train Show and Swap meet. It is open to all modelers. The models are judged by popular vote or by NMRA Achievement Program standards. Entrants must provide documentation for NMRA judging, but do not talk about their models. We are doing this this year because we cancelled the train show.

Superintendent: I have enjoyed being superintendent for the last year and a half. I do intend to complete this term as superintendent. However, I will not serve another term at this time. I hope to find something else to do with the NMRA at the national or regional level. With this in mind, I would like to establish a committee to find officer candidates for next year. I will serve on the committee. I'm looking for two other people to serve with me. You can volunteer or I will ask people. Thank you in advance for your help.

Clinics: The annual model challenge will need to be postponed until August or September. We are also planning a judged model contest for some Saturday or Sunday in September or October. There are five upcoming meetings of which two have events. Mark Juett has a clinic for an upcoming meeting, but I still need two clinics. At this time, I don't know if these meetings will be in person or virtual. Please consider presenting or recommending someone for a clinic in 2020. Also, the Lightning Slinger can use articles or pictures. Please consider contributing.

Gregory Ohlmacher  
Superintendent, Turkey Creek Division, NMRA

## OFFICERS

### Superintendent

Gregory Ohlmacher  
785-749-4502

[gcohlmac@sunflower.com](mailto:gcohlmac@sunflower.com)

### Paymaster

Bill Humenczuk  
HP:

[bhumenczuk@kc.rr.com](mailto:bhumenczuk@kc.rr.com)

### Clerk

Steve McKee

HP: 913-780-9009

[smckee@everestkc.net](mailto:smckee@everestkc.net)

### Division Director

John Fales

HP: 913-579-9541

[jtf@kidzdentist.com](mailto:jtf@kidzdentist.com)

### Membership Chair

Louis O Seibel

HP: 913-393-3495

C: 913-927-6850

[L-seibel@comcast.net](mailto:L-seibel@comcast.net)

### AP Merit Awards & Achievement

Joe B. Robertson, MMR

HP: 816-331-2773

[piperva@aol.com](mailto:piperva@aol.com)

### Lightning Slinger Editor

Ted Tschirhart

HP: 816-861-3449

[tedtschi@gmail.com](mailto:tedtschi@gmail.com)

### Lightning Slinger

[lightings@gmail.com](mailto:lightings@gmail.com)

### Past Superintendent

John Fales

HP 913-579-9541

[icatlalfred@gmail.com](mailto:icatlalfred@gmail.com)

### Web Master

Richard Kennedy

HP: 913-796-6830

[Richiekennedy56@gmail.com](mailto:Richiekennedy56@gmail.com)

### Web

<http://www.tc-nmra.org>

### Turkey Creek Division

Is a 501(C)(3)

ORGANIZATION



Turkey Creek Division will have an in-person meeting on June 23, 2020 at 7:00 PM.  
New Location: First Baptist Church of Kansas City, Missouri, 100 West Red Bridge Road, Kansas City, MO. Red Bridge Road is the same as College Boulevard in Kansas. (Map above)  
Please enter the church from the upper lot through doors with the blue awning. Once in the building make two left turns to get to the Fireside Room.

Clinic: Make and Take. Larry Diehl will do a presentation about construction of the model. A video will be shown for those people that are not working on their models. Larry has a few kits that he is willing to sell for those that didn't purchase a kit in advance. These are left over from last year and are not the Kokomo House that we sold this year.

**Face masks are required, and social distancing will be maintained.**

Please e-mail me at l-seibel@comcast.net if you are planning to attend.

**DVD that will be shown**

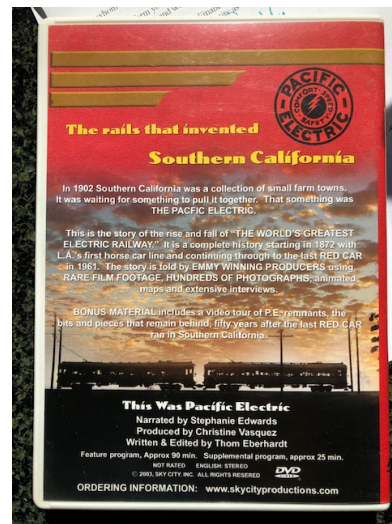
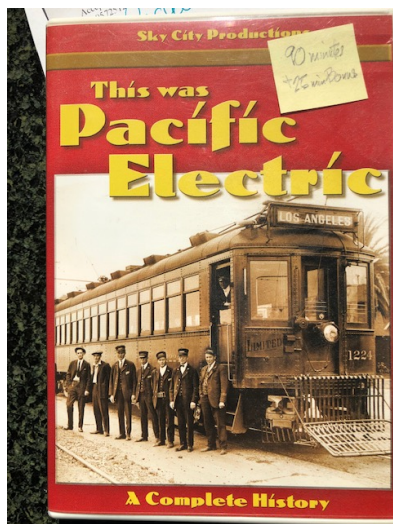

Wild West Scale Models Kits for Sale



HO Scale 222 Black Mine Sale Price \$76.14



HO Scale 201 Silverton House Sale Price \$118.44



Ho Scale 220 Federal Mine Scale Price \$67.68



Ho Scale 221 Quartz Hill Mine Sale Price \$81.21

Wild West Scale Models Kits for Sale



O-Scale 806 Fire House Sale Price \$65.13



O Scale 828 Track Side Warehouse Sale Price \$135.36

These all from Wild West Models which Larry Diehl purchased lats year. Any would make into a nice model for the clinic and would qualify in the contest as eligible for “make and take award.

Larry Diehl

# “Make and Take” Clinic

Scheduled April 28, 2020



## “Talking Points”

- This is not just a little square building!
- There are points of interest and character.
  - Ins and Outs ... “Shadlowlines”!
  - Includes a separate Out House!
- **There are special things about this kit to think about before the clinic meeting:**
  - 1) There is an interior ...  
(you do not have to build)
  - 2) Consider “texturing” walls before finish.
  - 3) Consider a color for stain or paint finish.
  - 4) Two (2) walls are to simulate wood log construction. Will you stain or paint?
  - 5) Roof material included to simulate wood shingles, do you want to color, stain or paint?

## Tools/Supplies

### **You should bring:**

- 1) Hobby knife, Exacto with #11 blades
- 2) Straight Edge – Metal Ruler – Cutting Edge
- 3) Square
- 4) Tweezers of your liking
- 5) Razzor Saw (if possible  $\pm 42$  teeth per inch)
- 6) Sharp Pencil
- 7) Scissors
- 8) Couple of small rags (9"x9" or 12"x12" or similar)
- 9) Paints or stains of your choice
- 10) Sandpaper/Sanding Sticks
- 11) Glue – white or yellow  
and/or  
5 minute epoxy  
and/or  
CCA – cyanoacrylate, "crazy glue"
- 12) Clamps

### **I will have:**

- 1) Cutting boards/tiles
- 2) Extra white glue
- 3) Several colors in solvent based stains
- 4) Bass wood bracing sticks  
(this model should require minimal bracing)
- 5) Paper towels, some extra rags



# “Make and Take” Model Suggested Steps to Build



## Step 1 - Wild West Model Photos - Weather your wood with razor saw...

Scrape pieces before you remove from the surroundings ...  
or leave together ...

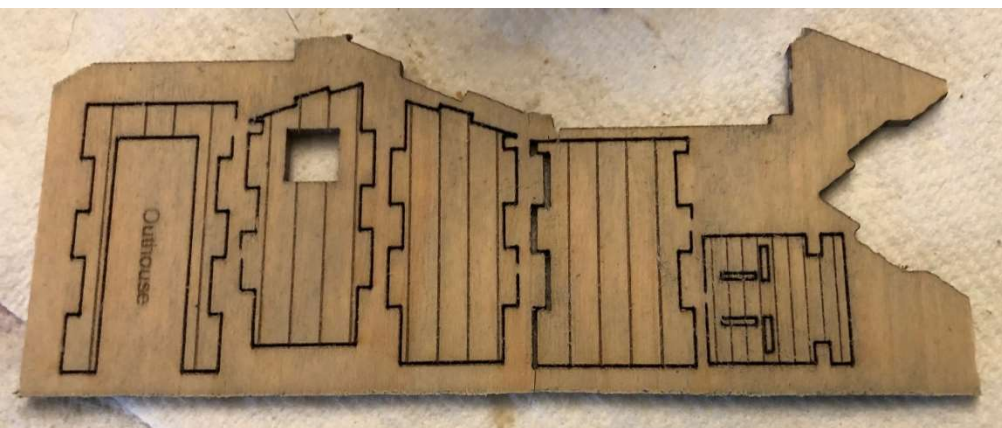

(if you want)  
Add “nail holes” with  
pounce wheel before staining



# Step 2 Stain your wood ...

- a) Sides ... floors ... trims ... roof sheathing ... and “sticks” ....
- b) Paint windows/doors

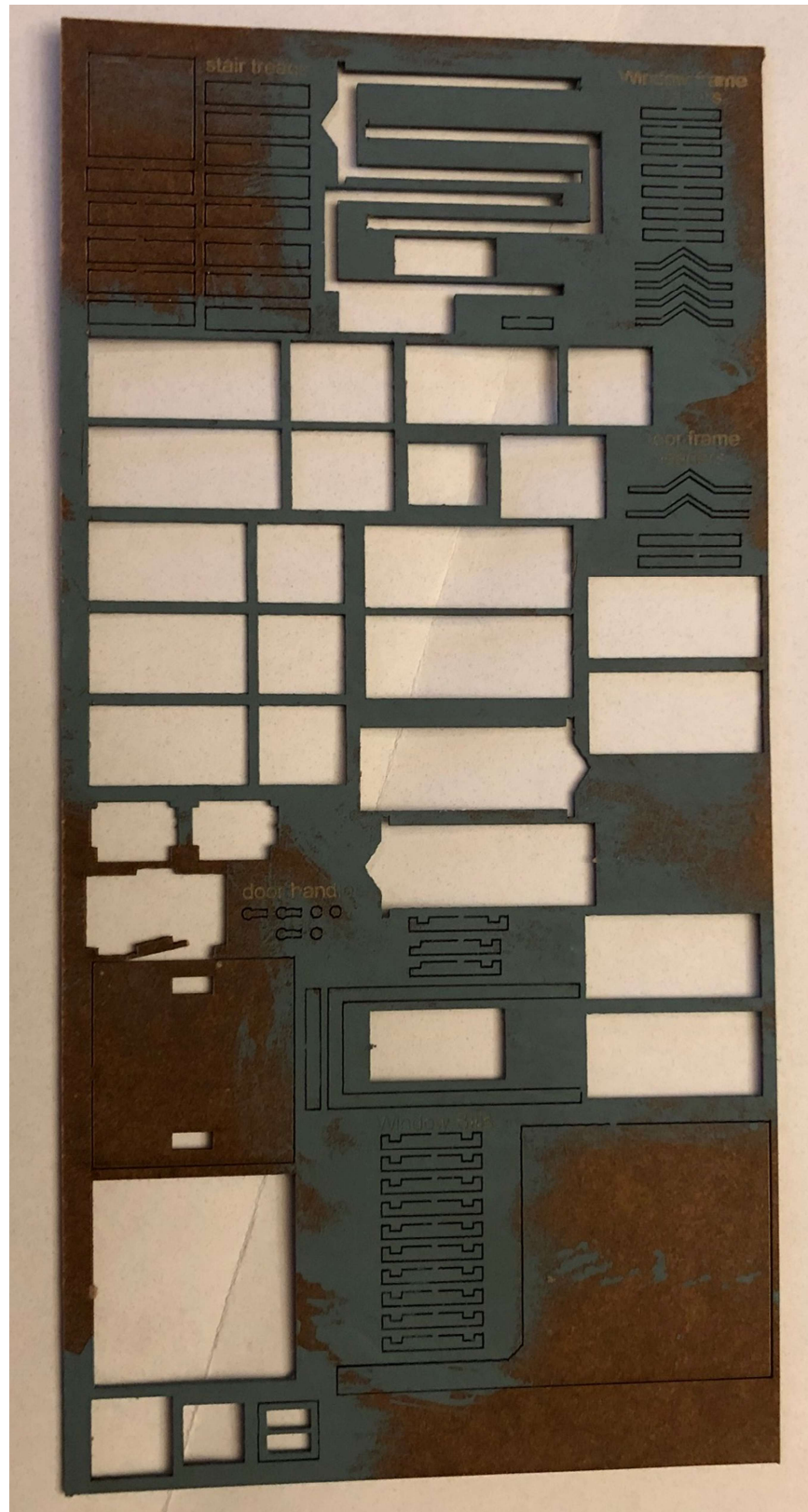

Paint white in  
the laser  
cutting sheet ...

# Step 3 Assemble Sub Units ...

- a) 3 log walls
- b) Rear add on
- c) Rear door "low" roof unit

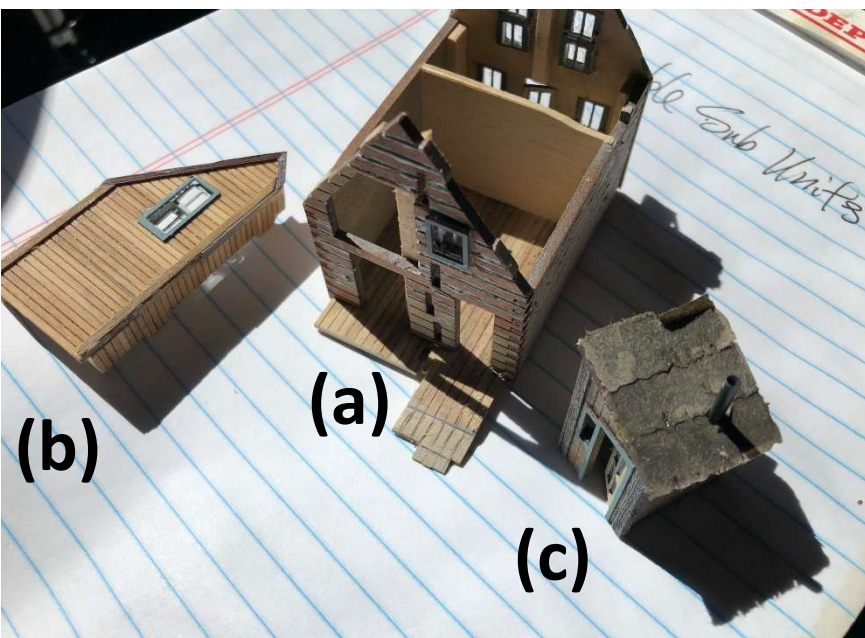

3 "log walls"  
(use floor insert to keep  
corners square)



3 "log walls"  
(a)

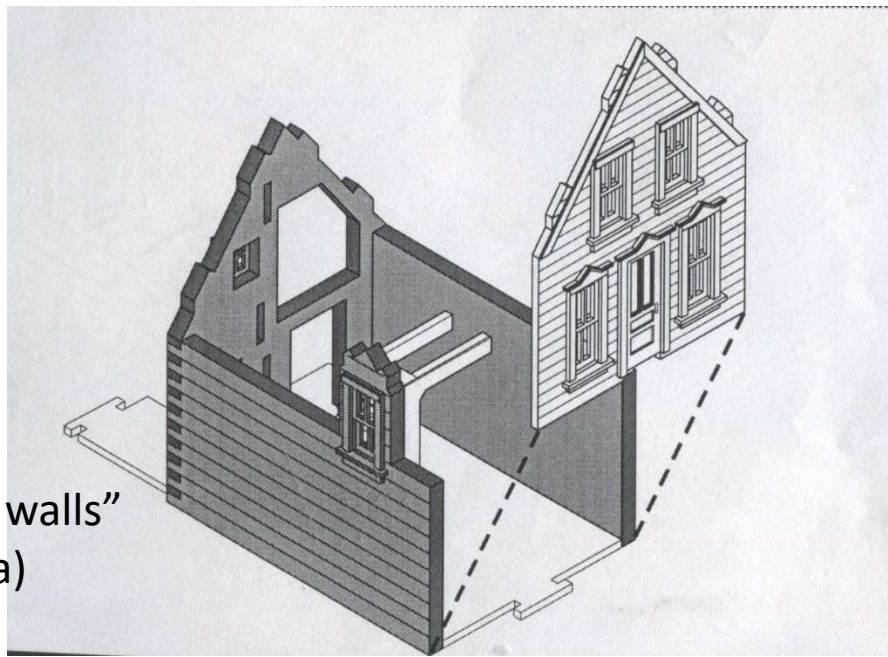

# Step 3 ...

## Assemble Sub Units ...

added to the main structure, or added one piece at a time.

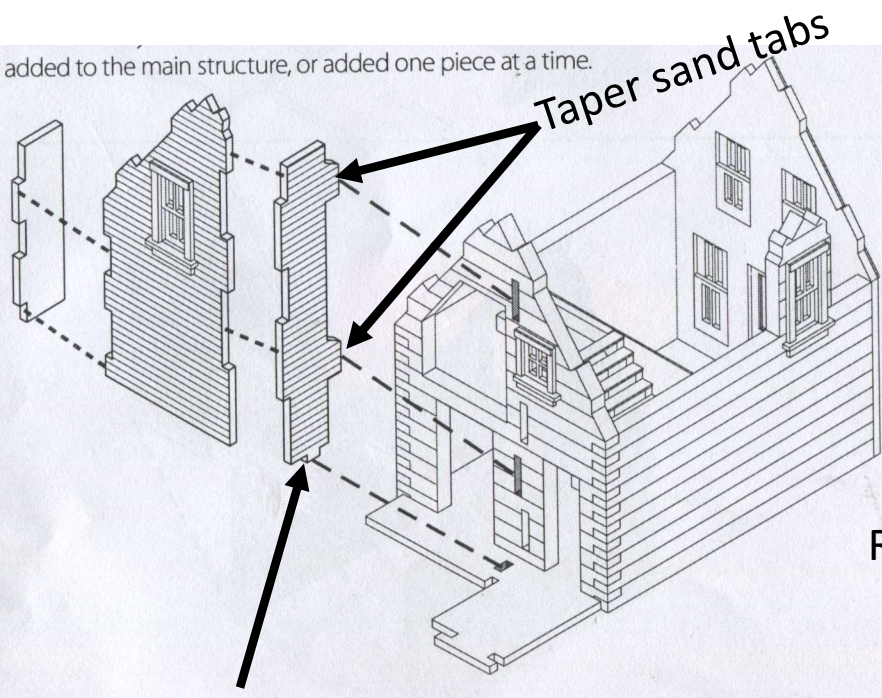

Remove this  
bottom tab

Rear add on  
(b)

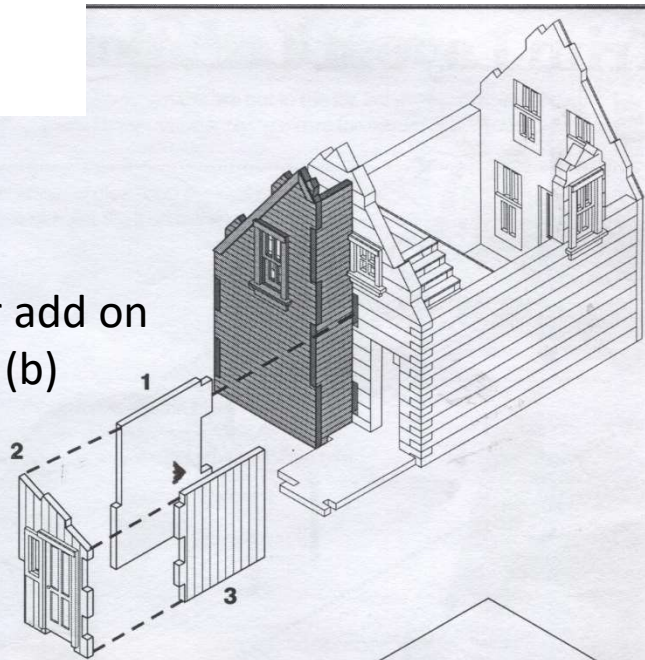

The 2nd floor inserts  
through the back log wall  
then rotates into place.  
No glue is needed.

Rear door  
low roof unit

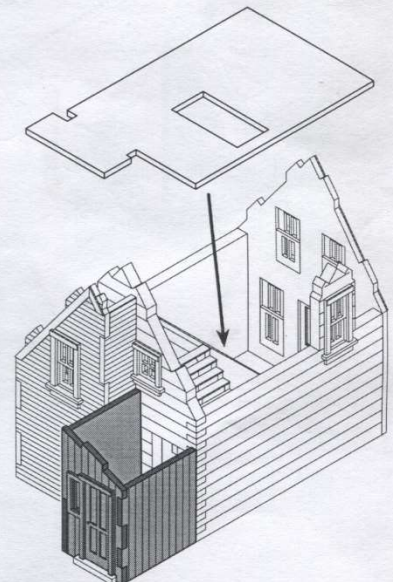

# Step 4 Paint Chinking ...

- White or off white ...
- I used “Martha Stewart” “wet cement”  
(I plan to have a couple of extra bottles)

This paint is simulating irregular filling between logs. I found I could not use a brush. I tried a toothpick and steel point awl; did not work for me.

I used the long sharp edge of my exacto #11 blade. Touch the sharp edge into a “goob” of paint and touch into joint, painting only 1/4” to 1/2” each touch. It takes some time, but worked to my satisfaction.

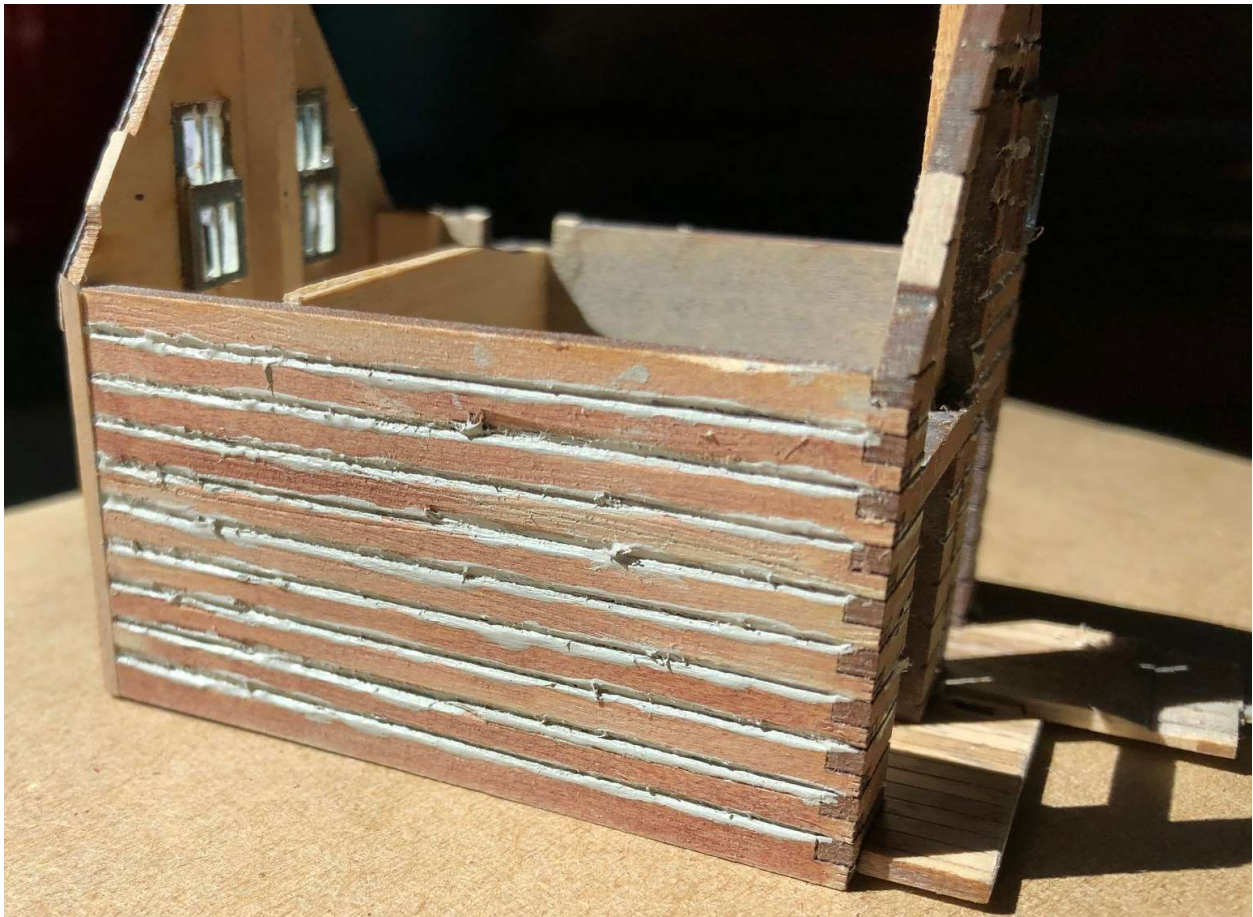

# Step 5 Paint Windows/Doors ...

(select paint colors you want)

## Windows/Doors in walls

**1** The following two steps illustrate how to install any two part windows and doors included in this kit. v

### Typical Window/Door Assembly Steps

1. gently fit upper sash into wall
2. glue upper sash glazing in place
3. fit lower sash into position
4. glue lower sash glazing in place

The sprue indicates the position of the window

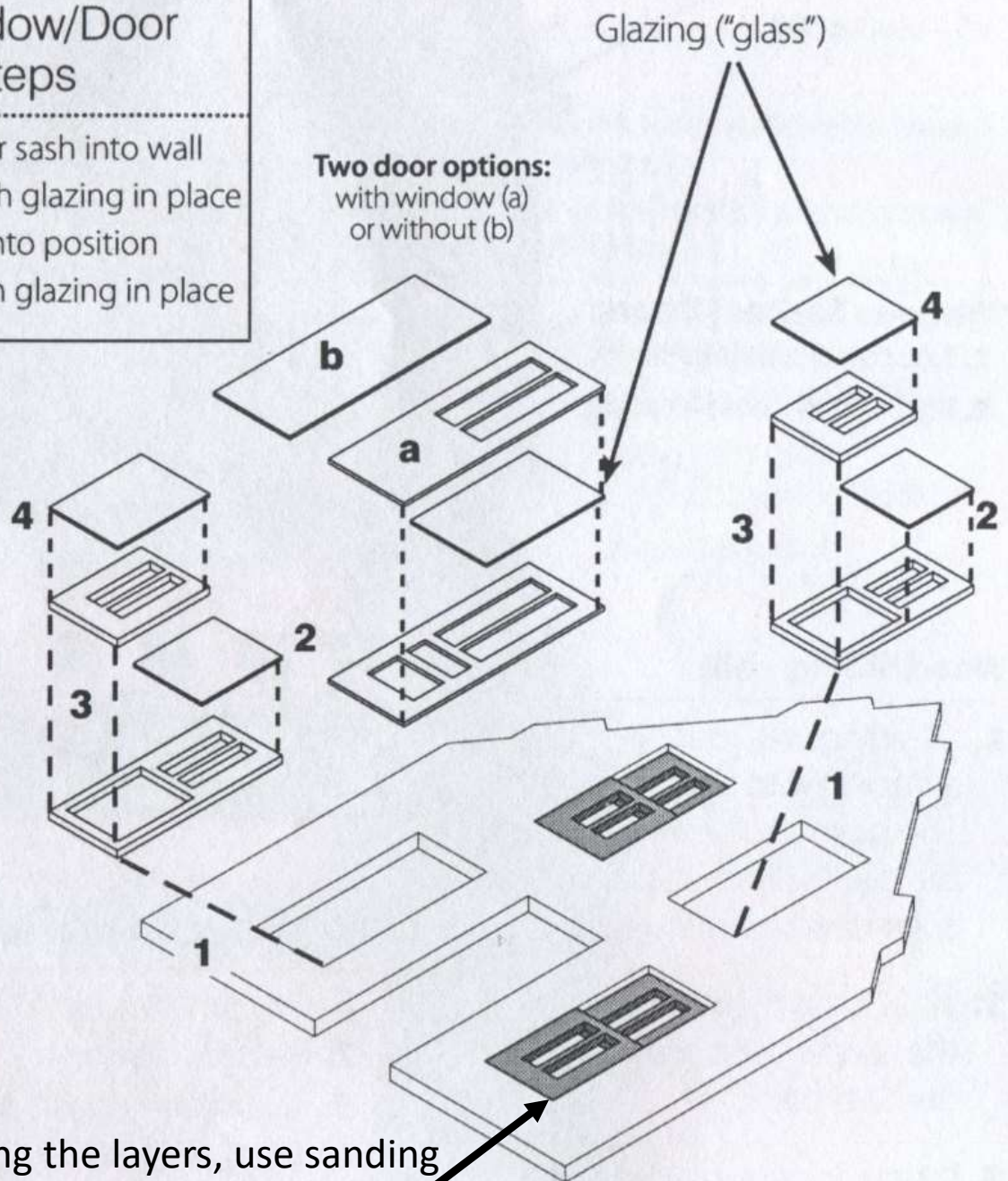
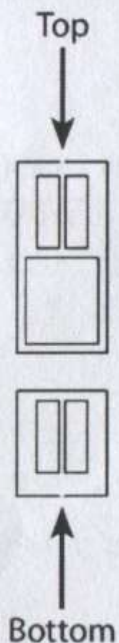

After gluing the layers, use sanding stick to fit into wall openings

# Step 6 Install Windows/Doors ...

- 1) Place and glue windows in holes
- 2) Place and glue trims

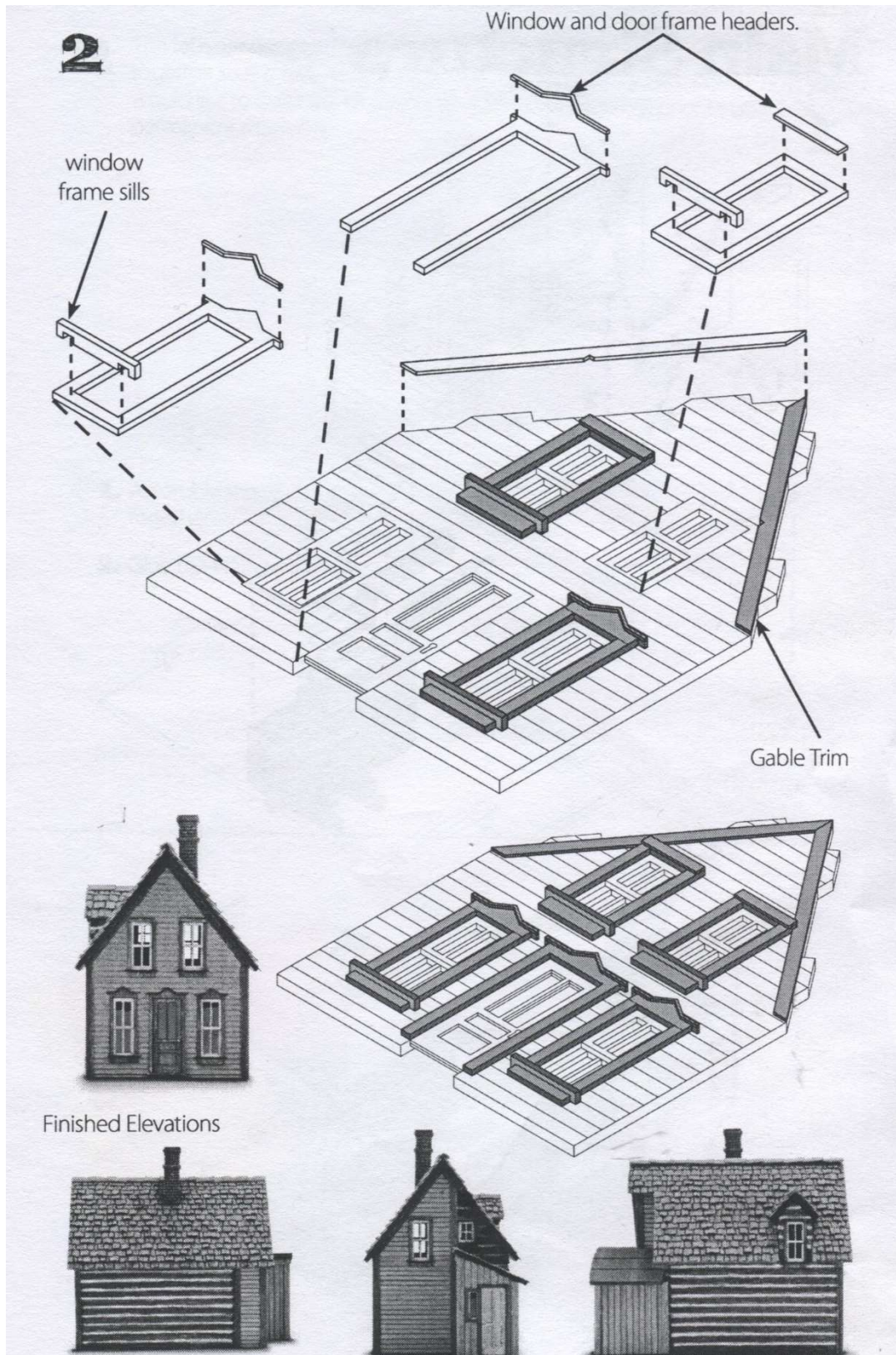

# Step 7 • Taper some tabs

- Remove/sand off some tabs

This kit fits so precisely well, it makes it difficult to “snap” together sub assemblies.

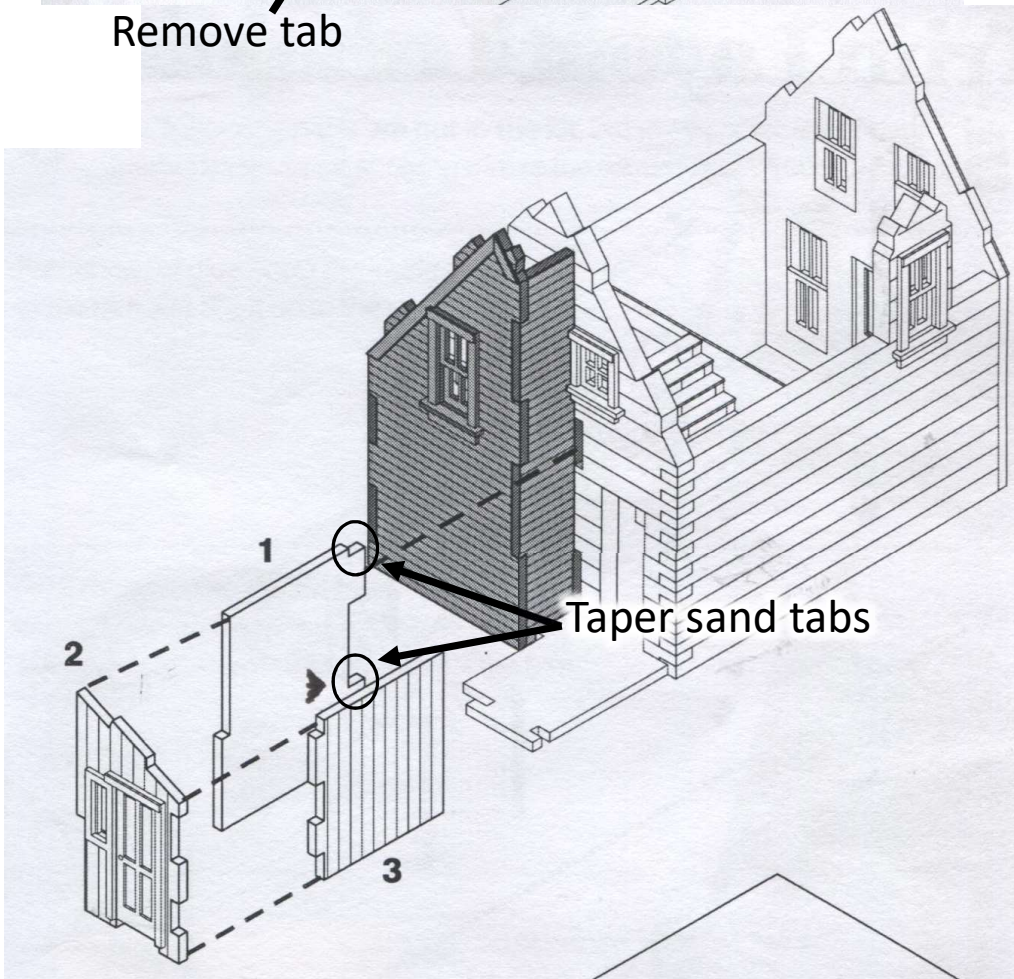
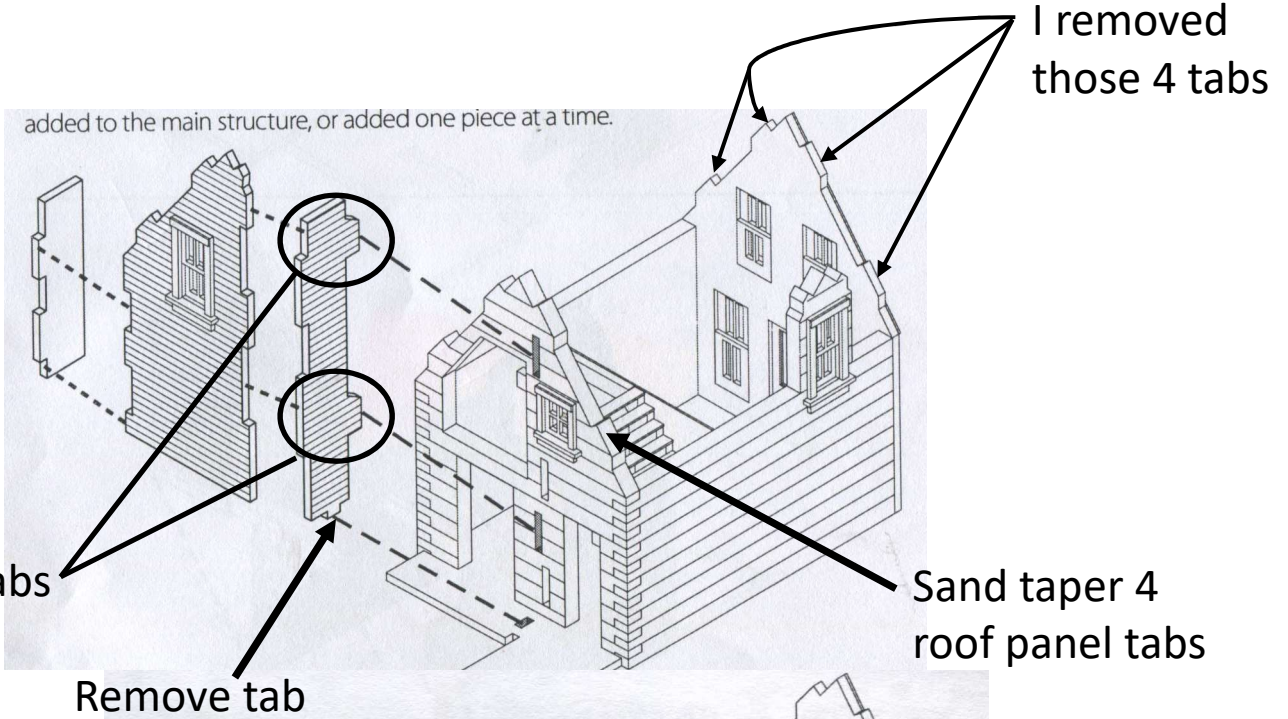

# Step 8

## Assemble Roof Panels ...

“Keep the roof loose for now”

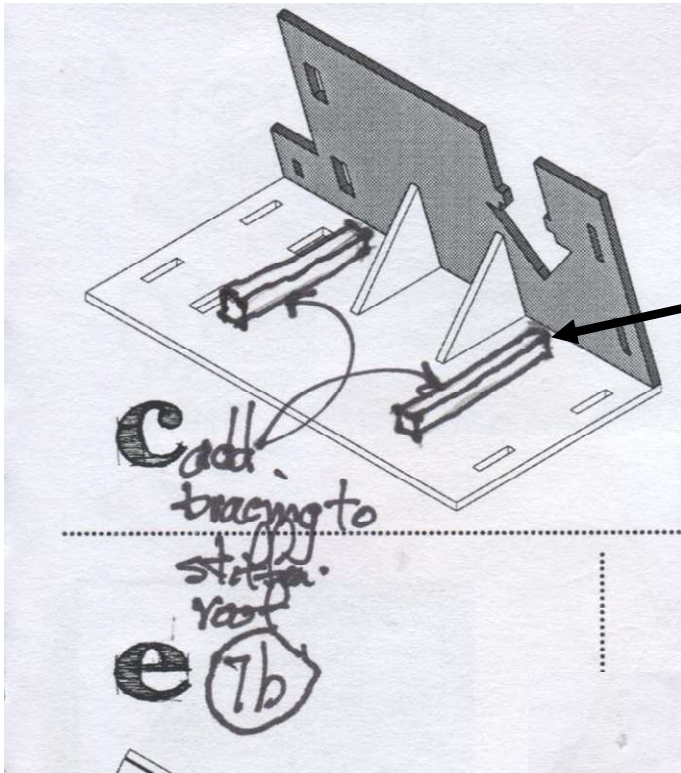
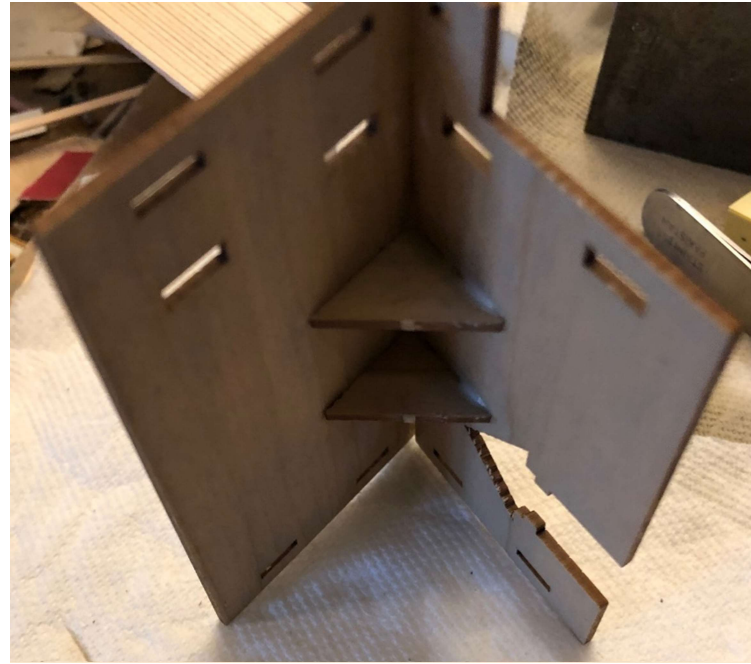

Add “stiffener” braces to back (underside) of roof panels

2<sup>nd</sup> ...  
Add Dormer Roof

First -  
Add Dormer Window Pieces  
(side wall triangles)  
glue to roof panels

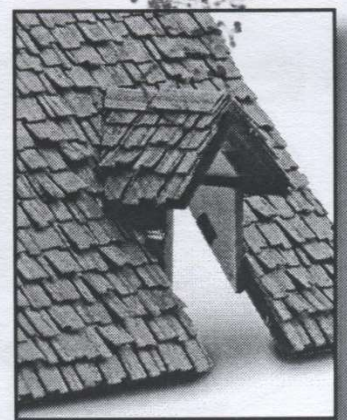
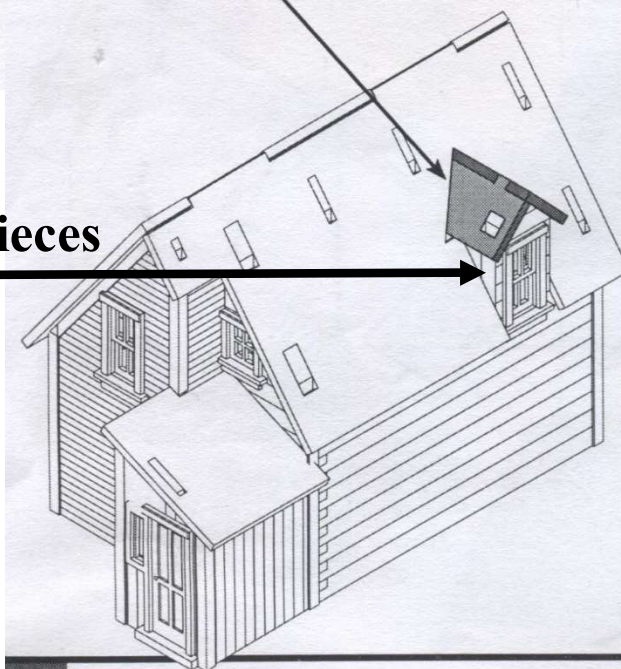



# Step 9 Add Corner Trims ...

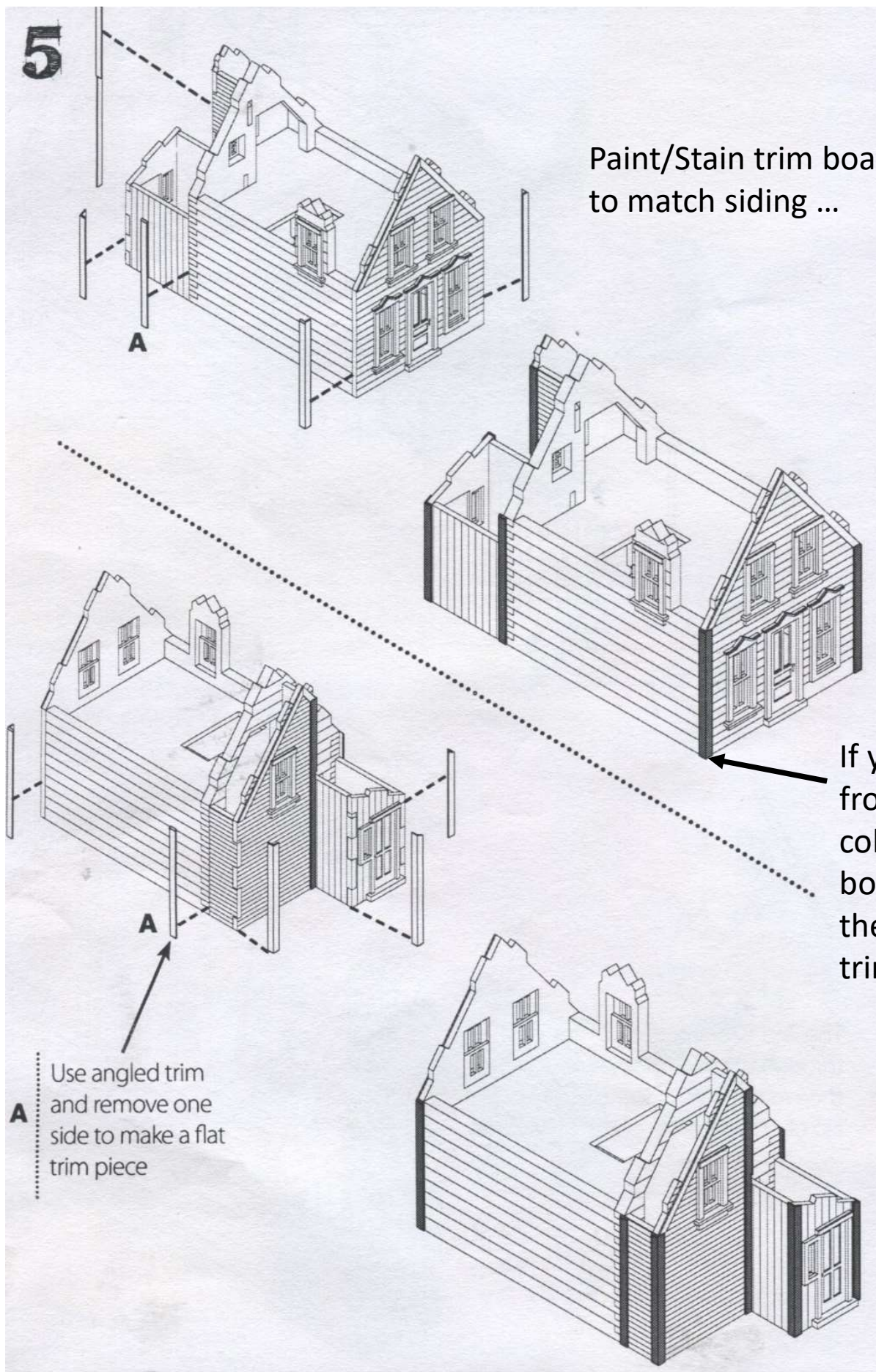

# Step 10

## Assemble the Out House ...

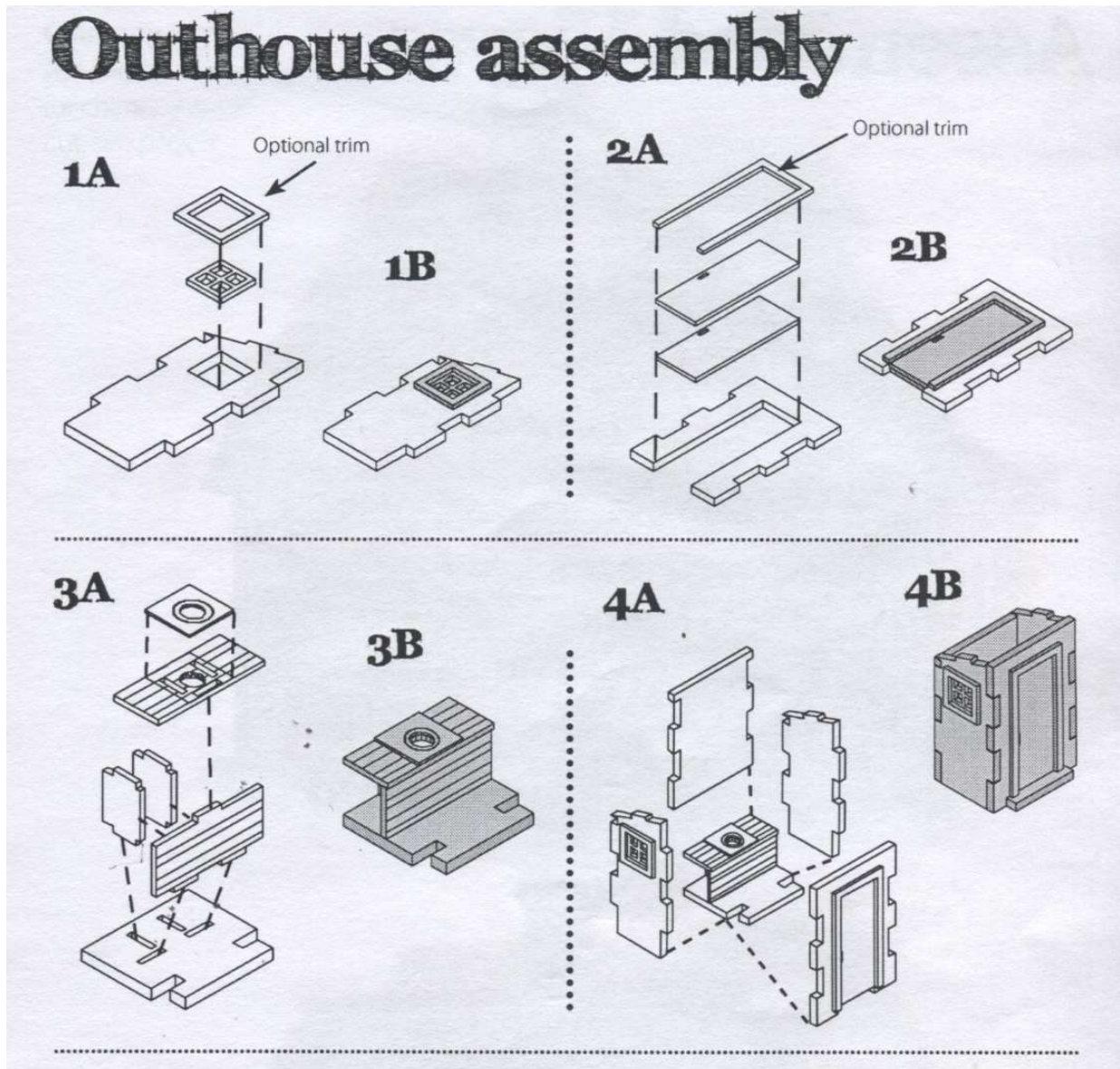

Install roof very last to allow you to glue in the seat and enclosure.

The kit comes with doors that have a "moon" cut out.

# Step 11 Apply the Shingles ...

## Shingle Application:

- ▶ Color edges of the roof black to simulate tar.
- ▶ Apply shingles with glue, overlapping to desired look. **or 5 min epoxy!**
- ▶ Trim excess with scissors.
- ▶ Add ridge cap strip, or cut the strip along the printed lines and overlap individual pieces.

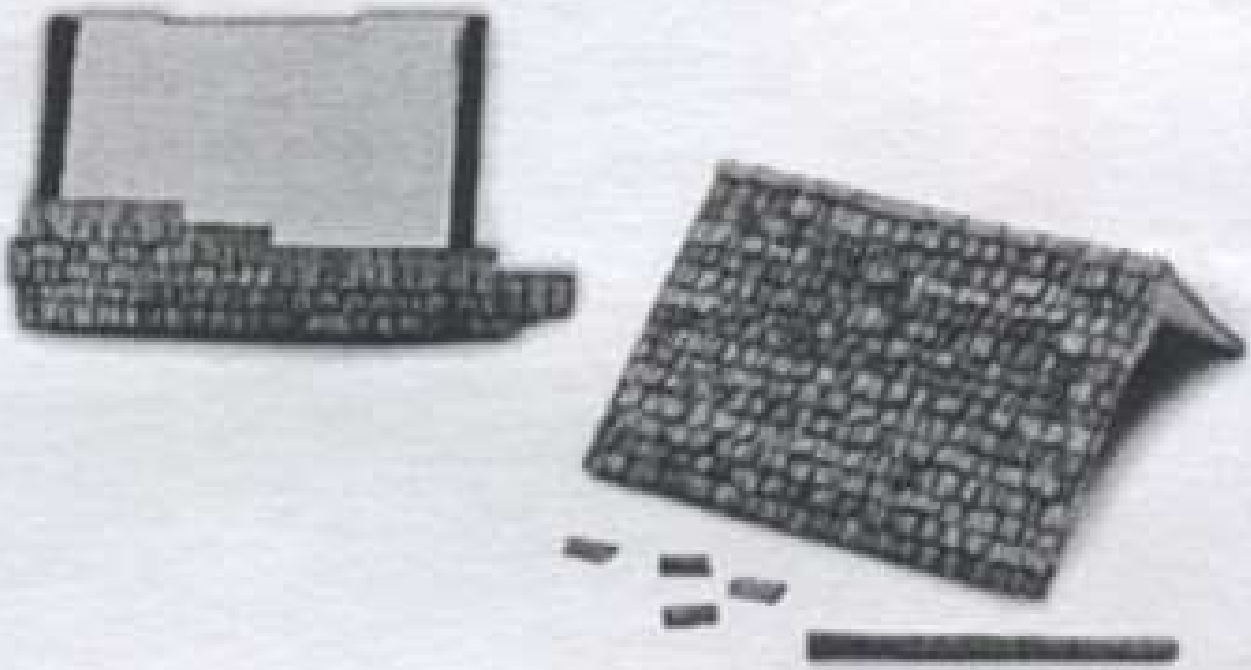

# Step 12 Make the Roof Chimney ...

(use angle in book to cut slope)

- a) Paint chimney "red brick"
- b) Paint stone square "grayish or tannish"
- c) Cut angle of match to roof ... using drawing in book as template
- d) Glue in "stone" squares
- e) Paint inside of top black ...
- f) Glue to roof

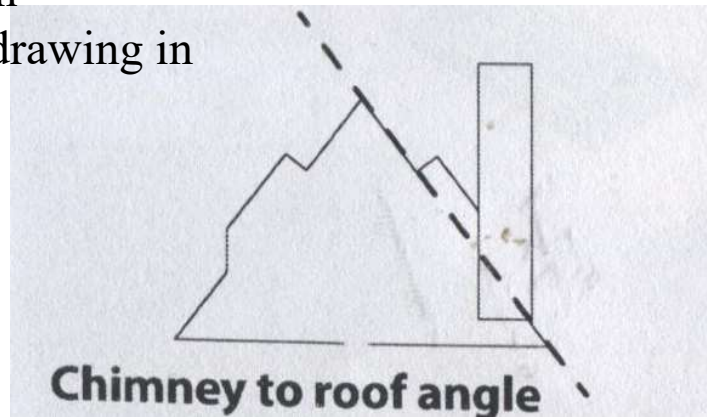

## Chimney Assembly detail:

1. Cut chimney 3, 4 or 5 brick courses from top.
2. Insert small piece.
3. Glue chimney together.
4. Add layered chimney caps, small, big, small as in picture.

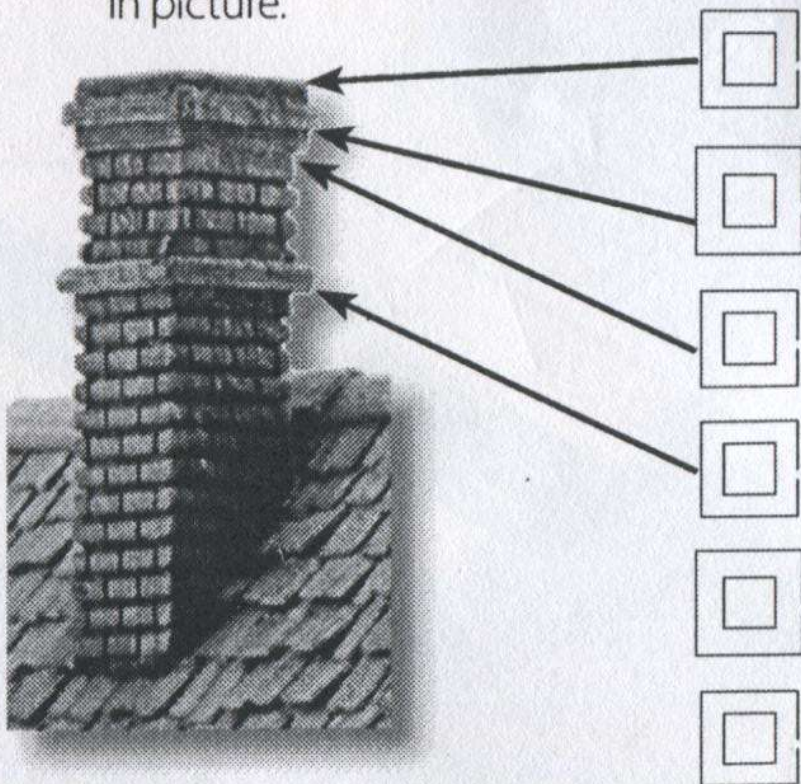

# My demo model ...



# FORKS CREEK CURRENT

VOLUME 11 - A RANDOMLY OCCURRING PUBLICATION By: Ron Morse, MMR

Okay I did a little more today.....But first some the tools etc.



- Some of the brushes I use to move the powdered granite around.
- Small fan I use to dry the scenery.
- Assorted sifters I use for different grain sizes of granite. Actually I have them going from 1/4 inch to about 120





On the left is my bucket of decomposed granite and on the right is what's left after I have sifted it. I have maybe another half bucket of the non-sifted decomposed granite. Boy I wish my dad still had his assay office at Blackhawk, Colorado as he had an electric pulverizer that you could adjust to take samples down to most any size!

It's hard to tell it in the photo below but I have sifted a layer of the super fine granite as a top coat over the courser material (on the left side around the freight depot).

